

Frequently Asked Questions

Karrinyup Road Off-Ramp Closure

What's happening?

As part of the *Mitchell Freeway Pedestrian and Cyclist Path – Civic Place to Reid Highway Project*, Main Roads will be constructing an 80 metre underpass at Karrinyup Road.

To enable safe construction of the underpass, the Karrinyup Road off-ramp from Mitchell Freeway southbound will be closed for upto 20-weeks.

When will the closure take place?

The closure is expected to be implemented from Thursday 16 June 2022 through to mid-November.

Will there be any other impacts?

Yes, in addition to the ramp closure, road users will face the following restrictions:

- Traffic signals will be switched off at both the Mitchell Freeway northbound and southbound intersections with Karrinyup Road meaning Karrinyup Road will operate under free flow traffic conditions with a single lane in each direction (east/west).
- The Mitchell Freeway southbound on-ramp will be closed to eastbound traffic along Karrinyup Road. Westbound traffic toward Mitchell Freeway southbound may be intermittently disrupted.
- The Mitchell Freeway northbound off-ramp will become left-turn only.
- The Mitchell Freeway northbound on-ramp will be closed to the westbound traffic along Karrinyup Road, eastbound traffic will still be permitted.
- PSP users (on the west side of the Mitchell Freeway) will be detoured to the protected signalised crossing at North Beach Road (approximately 640 metres total detour length).

Plan ahead with our Travel Map <https://travelmap.mainroads.wa.gov.au>

Local residents should expect to hear noise during construction however, to minimise the impact as much as possible, work will predominantly be undertaken during daylight hours.

Why do you have to close the off-ramp?

Main Roads traffic modelling indicates that these temporary traffic management changes will provide the highest level of safety for roadworkers, and the best outcome for the community.

How else can I get to Osborne Park Hospital?

Exit at Cedric Street, turn left on Karrinyup Road and left again on Dennis Street.

Frequently Asked Questions

Karrinyup Road Off-Ramp Closure

How else can I get to Karrinyup Shopping Centre?

- Reid Highway and Marmion Avenue
- Erindale Road and North Beach Road; or
- Cedric Street and Huntriss Road

Detour map – Mitchell Freeway southbound access to Karrinyup Road westbound

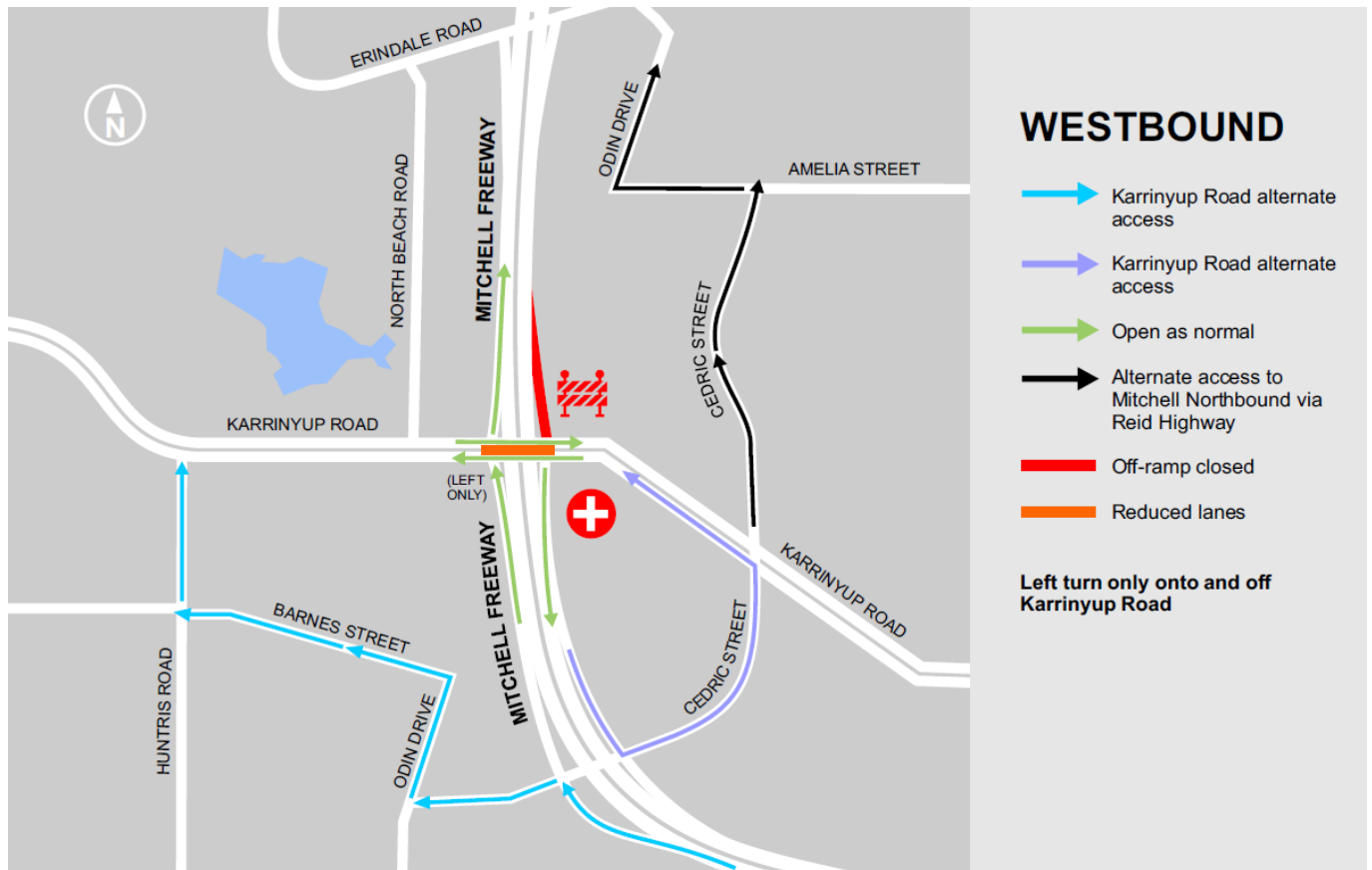

Frequently Asked Questions

Karrinyup Road Off-Ramp Closure

Detour map – Mitchell Freeway southbound access to Karrinyup Road eastbound

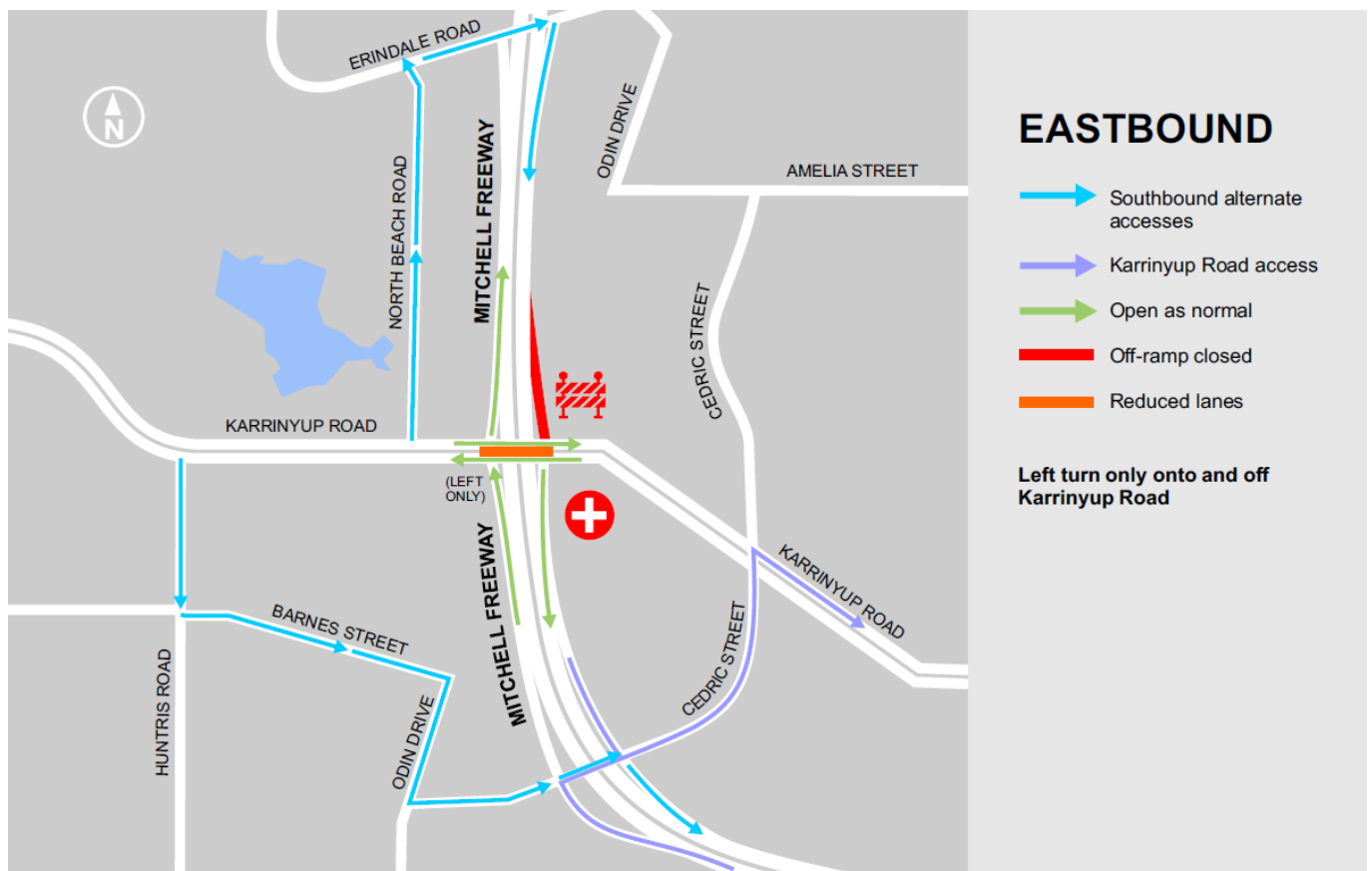

Where can I find out more?

- Call our Customer Information Centre on 138 138
- Email enquiries@mainroads.wa.gov.au