

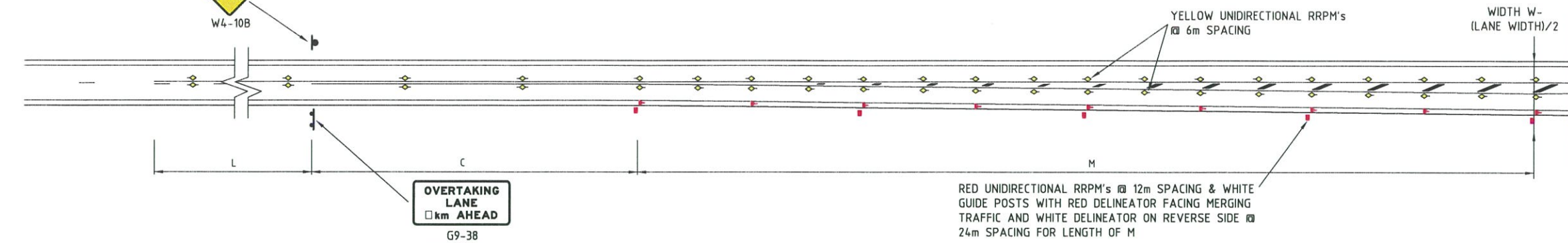

W4-10B



OVERTAKING LANE
□ km AHEAD

G9-38
(SEE NOTE 4)

RED UNIDIRECTIONAL RRPM's @ 12m SPACING & WHITE GUIDE POSTS WITH RED DELINEATOR FACING MERGING TRAFFIC AND WHITE DELINEATOR ON REVERSE SIDE @ 24m SPACING FOR LENGTH OF M

OPTION 3
(RIGHT LANE TAPERS TO LEFT)
(LEFT LANE TAPERS TO RIGHT)

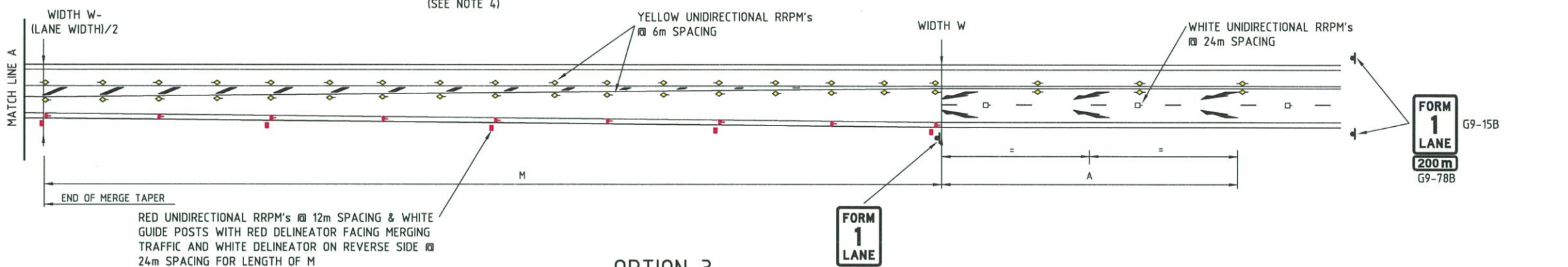

OVERTAKING LANE
□ km AHEAD

G9-38
(SEE NOTE 4)

RED UNIDIRECTIONAL RRPM's @ 12m SPACING & WHITE GUIDE POSTS WITH RED DELINEATOR FACING MERGING TRAFFIC AND WHITE DELINEATOR ON REVERSE SIDE @ 24m SPACING FOR LENGTH OF M

OPTION 4
(RIGHT LANE TAPERS TO LEFT)
(LEFT LANE TAPERS TO RIGHT)

V ₈₅ km/h	A m	C m	M m	LENGTH OF BARRIER LINE (L)	
				MIN (m)	DESIRABLE (m)
60	80-120	30	100	96	132
70	80-120	30	115	108	156
80	120-180	60	130	120	180
90	120-180	60	145	132	204
100	180-250	100	160	144	228
110	180-250	100	175	168*	252*

* FOR ROAD TRAIN ROUTES USE MINIMUM 300m



AMENDMENTS

No.	DATE	DESCRIPTION	APPROVED
1	12.4.16	RED UNIDIRECTIONAL RRPM NOTES AMENDED	AKOORELEVEL 12.4.16
2	3.5.16	MIN BARRIER LENGTHS IN TABLE AMENDED	<i>[Signature]</i> 3/5/16

NOTES

NOTES:

- THESE OPTIONS SHOULD ONLY BE USED ON EXISTING MERGES THAT DO NOT MEET CURRENT ROAD DESIGN GUIDELINES. THEY SHOULD NOT BE USED FOR NEW MERGES. FOR STANDARD MERGE TREATMENTS SEE DWG No's. 200631-0039 AND 201431-0021.
- THESE OPTIONS SHOULD ONLY BE USED WITH THE APPROVAL OF MANAGER ROAD AND TRAFFIC ENGINEERING.
- OPTION 1 ON DWG. 201431-0038 IS PREFERRED BUT OPTION SELECTION WILL DEPEND ON ACTUAL SITE CONDITIONS SUCH AS SIGHT DISTANCE, HORIZONTAL AND VERTICAL ALIGNMENT.
- WHERE THERE ARE LIMITED OVERTAKING OPPORTUNITIES BETWEEN CLOSELY SPACED OVERTAKING LANES, INSTALL SIGN G9-38 (WITH APPROPRIATE DISTANCE) A DISTANCE OF "C" METRES PAST THE END OF THE MERGE TAPER TO INDICATE THE DISTANCE TO THE NEXT OVERTAKING LANES.
- G9-15B SIGN TO BE DOUBLED UP ONLY ON DUAL CARRIAGEWAY ROADS.
- FOR DIMENSIONS OF MERGE PAVEMENT ARROWS REFER TO AS 1742.2. USE OF MERGE ARROWS IS MANDATORY.
- THIS DRAWING AND DWG. NO. 201431-0038 SUPERSEDE DWG. NO. 200931-0010.

LEGEND

- ▶ RED UNIDIRECTIONAL RRPM
- RED GUIDE POST
- ◇ YELLOW BIDIRECTIONAL RRPM
- ◇ YELLOW UNIDIRECTIONAL RRPM
- WHITE UNIDIRECTIONAL RRPM

TECHNOLOGY AND ENVIRONMENT DIRECTORATE
 ROAD AND TRAFFIC ENGINEERING
 WATERLOO CRESCENT Telephone (08) 93230411 EAST PERTH 6004 Fax (08) 9323 4449

DESIGNED / DRAWN	D.LANDMARK/J.VOKE	10.11.14
VERIFIED	D.LANDMARK	21.11.14
APPROVED	B.SNOOK	21.11.14

STANDARD DRAWING
 SIGNS AND LINE MARKING
 FOR OVERTAKING LANES
ALTERNATIVE MERGE TREATMENTS
 2 OF 2

LOCAL AUTHORITY _____ AMENDMENT _____

201431-0039-2