

STRAINER ASSEMBLY - SINGLE STAY

USE AT ENDS AND GATE LOCATIONS AND AS CORNER ASSEMBLY WHERE DEFLECTION ANGLE IN FENCE LINE IS UP TO 30° DIAGONAL STAY TO BISECT INTERNAL ANGLE

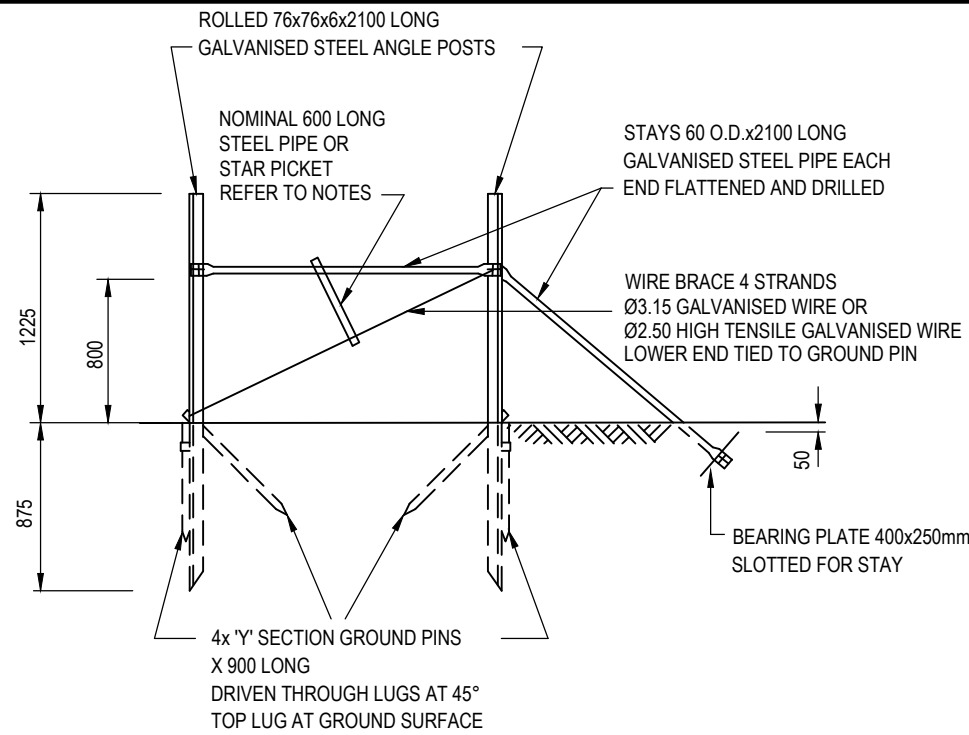

STRAINER ASSEMBLY - DOUBLE STAY

CONSTRUCTED FROM TWO SINGLE STAY STRAINER ASSEMBLIES FOR ENDS AND GATE LOCATIONS IN POOR HOLDING SOILS ONLY

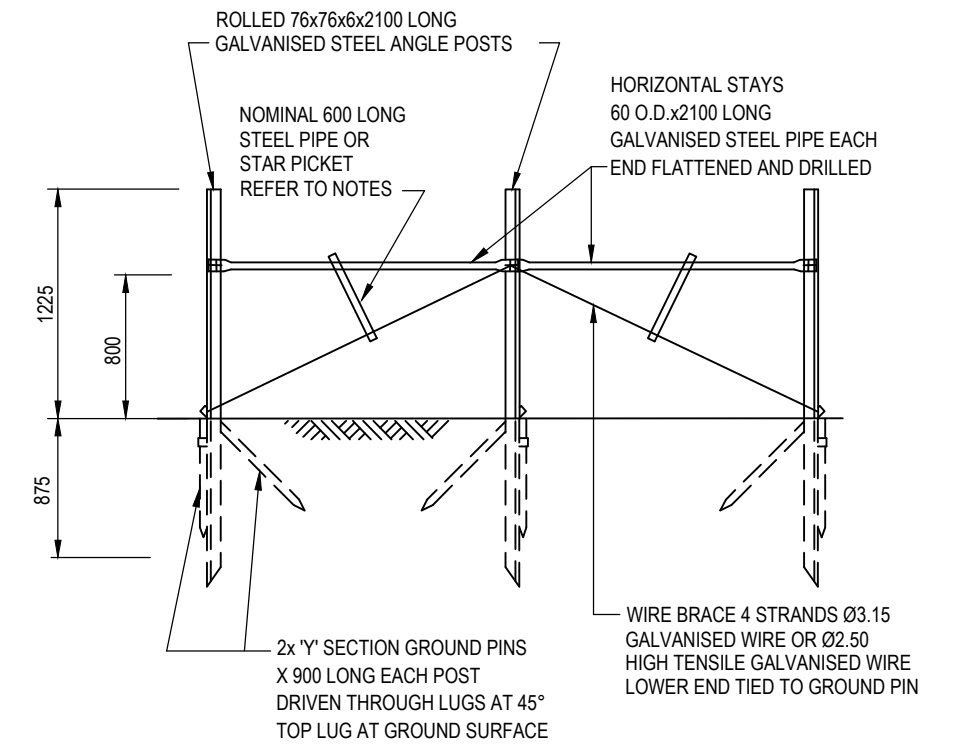

CORNER STRAINER ASSEMBLY

USE WHERE DEFLECTION ANGLE IN FENCELINE IS GREATER THAN 30°

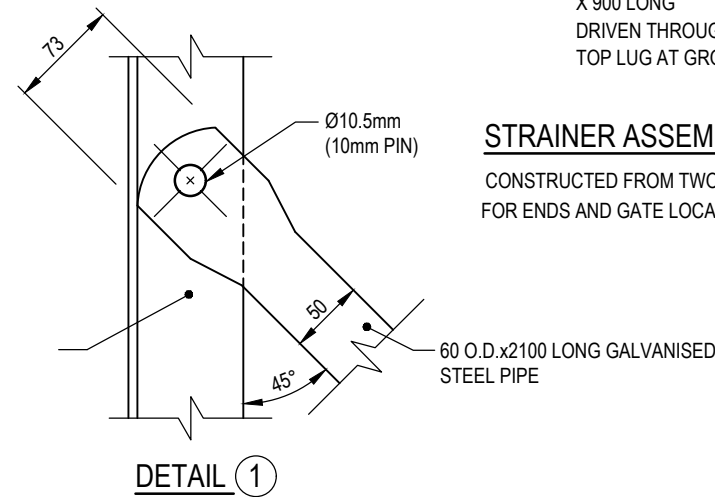

DETAIL 1

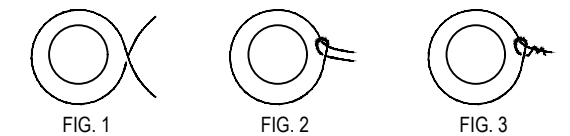

METHOD OF TYING OFF AT STRAINER ASSEMBLIES

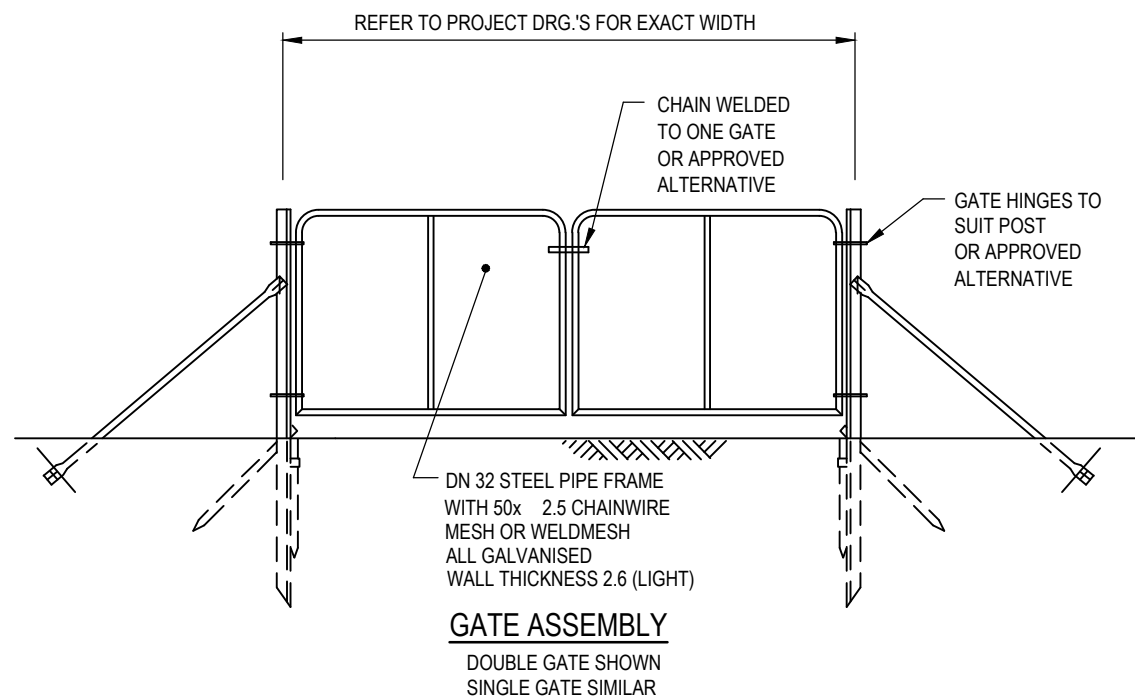

GATE ASSEMBLY

DOUBLE GATE SHOWN SINGLE GATE SIMILAR

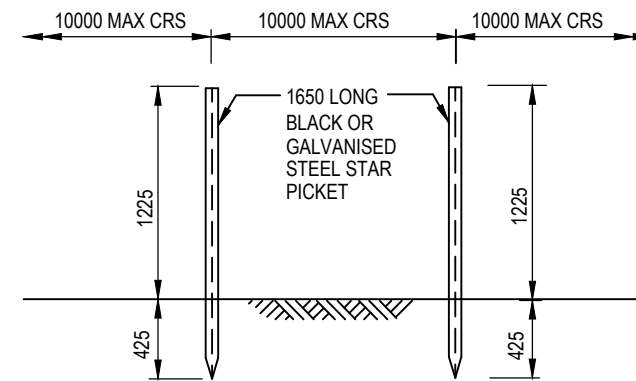

FENCE POSTS

USE ON STRAIGHTS

DRAWING REFERENCES

| | |
|---------------------------------|-------------|
| AGRICULTURAL FENCING DETAILS | 200331-0096 |
| PREFABRICATED FENCEWIRE DETAILS | 200331-0097 |
| PLAIN FENCEWIRE DETAILS | 200331-0098 |

NOTES

- FENCING TO BE SUPPLIED AND INSTALLED IN ACCORDANCE WITH AUSTRALIAN STANDARD AS 1725 AND MAIN ROADS SPECIFICATION 903 FENCING.
- DIMENSIONS SHOWN ON THIS DRAWING ARE TYPICAL.
- GALVANISING TO BE IN ACCORDANCE WITH AUSTRALIAN STANDARDS AS 4680 AND 4792.
- POSTS TO BE VERTICAL WITH TOLERANCE 1: 50.
- WIRE TO BE TENSIONED BETWEEN PAIRS OF ANCHORAGE POINTS. ANCHORAGE POINTS ARE TO BE LOCATED AT ALL CHANGES IN FENCE DIRECTION AND AT SPACING NO GREATER THAN 200m.
- POSTS TO BE BURIED OR DRIVEN TO DEPTHS AS SHOWN UNLESS OTHERWISE SPECIFIED.
- STRAINER POSTS TO BE USED IN LIEU OF FENCE POSTS WHERE SHOWN ON FENCE LAYOUT DRAWINGS AND WHERE INSTRUCTED BY THE SUPERINTENDENT.
- POSTS TO BE EQUALLY SPACED BETWEEN CHANGES IN FENCE DIRECTION WITH CENTRES NOT EXCEEDING 10m EXCEPT WITH END STRAINER ASSEMBLY.
- ALL END STRAINERS SHALL BE OFFSET SO THE FENCE WIRES FOLLOW A STRAIGHT LINE.
- STRAINER ASSEMBLY TO BE AS SHOWN OR PREFABRICATED APPROVED EQUIVALENT.
- DIAGONAL WIRE BRACE STRANDS TO BE TENSIONED BY INSERTING A LENGTH OF STEEL PIPE (OR STAR PICKET) AND ROTATING ABOUT THE STRANDS. THE OUTER END OF THE PIPE SHALL BE PROPPED BEHIND THE HORIZONTAL STRUT ONCE THE STRANDS ARE FULLY TENSIONED. BOTH ENDS OF THE PIPE TO BE SECURED WITH WIRE TIES.
- ALL UNITS ARE IN MILLIMETRES UNLESS OTHERWISE NOTED.

1

| | | |
|------------|--------------------------------|-----------------|
| 1 | TITLE BLOCK & FILE No. UPDATED | A.Wong 26/10/23 |
| No. | DESCRIPTION | APPROVED & DATE |
| AMENDMENTS | | |

| | | |
|--|----------|-----------------------|
| <p>PLANNING AND TECHNICAL SERVICES DIRECTORATE ROAD AND TRAFFIC ENGINEERING BRANCH Waterloo Crescent Telephone 138 138</p> | DRAWN | RTE BRANCH |
| | DESIGNED | M. VASEV 14.06.05 |
| | VERIFIED | J. KARPINSKI 15.06.05 |
| | APPROVED | W. CANNELL 15.06.05 |
| | FILE NO. | 13/4330 |

| | |
|--|-----------|
| STANDARD DRAWING FENCING STEEL ANGLE STRAINER AND POST DETAILS | |
| MRWA DRAWING NUMBER | AMENDMENT |
| 200331-0103-1 | |

NOT TO SCALE
A3