

TYPICAL MAX POST SPACINGS - BOUNDARY 10000 CRS
 SMALL PADDOCKS 5000 CRS
 HIGH STOCK CONCENTRATION 5000 CRS

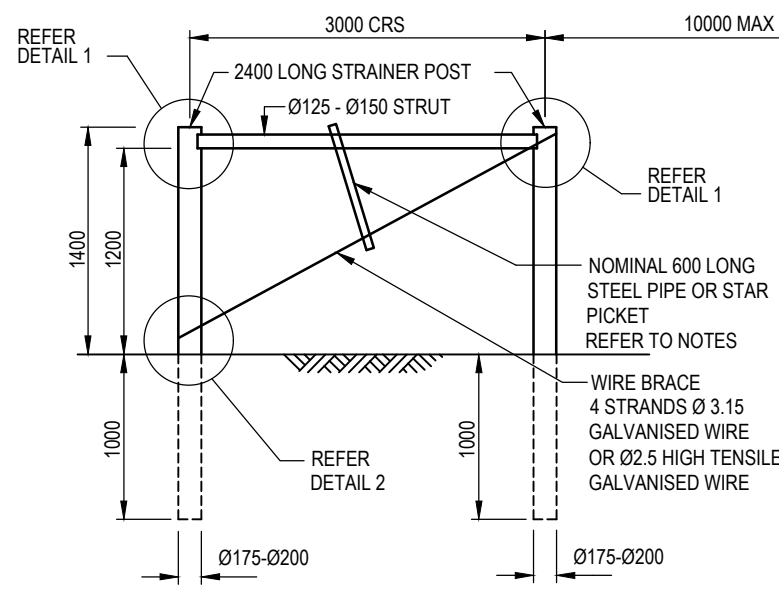

END STRAINER ASSEMBLY
 FOR ENDS AND GATES

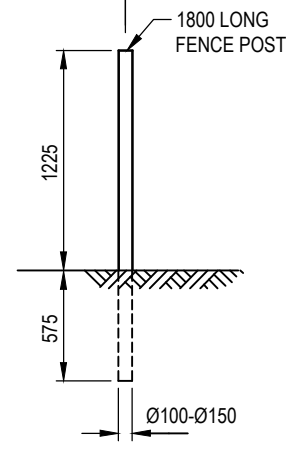

FENCE POST
 USE ON STRAIGHTS

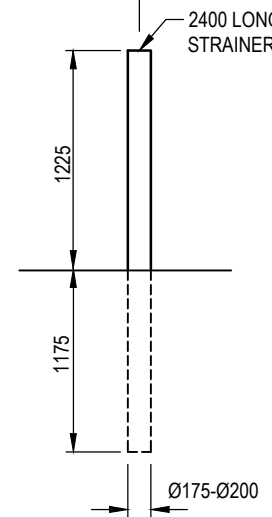

STRAINER POST
 REFER TO NOTES

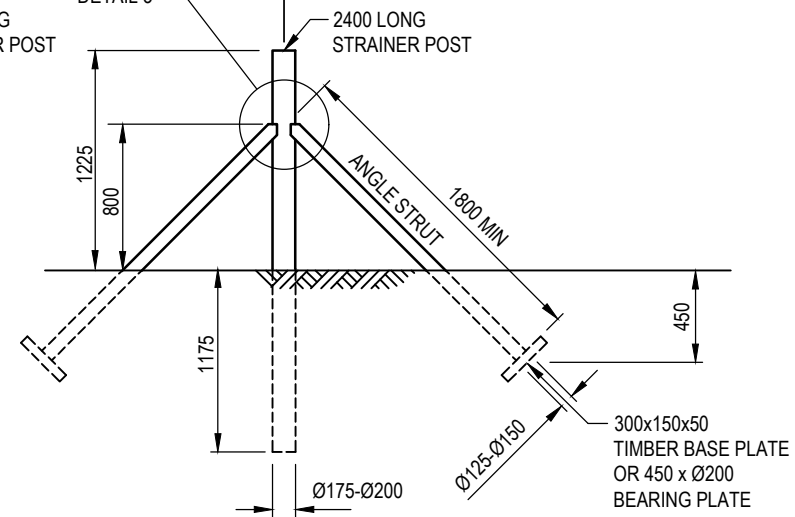

CORNER STRAINER ASSEMBLY
 USE WHERE THERE IS ANY CHANGE IN DIRECTION OF FENCELINE UP TO 30°
 ALTERNATIVE:
 SINGLE ANGLE STRUT AT 90° TO FORCE OF STRAIN

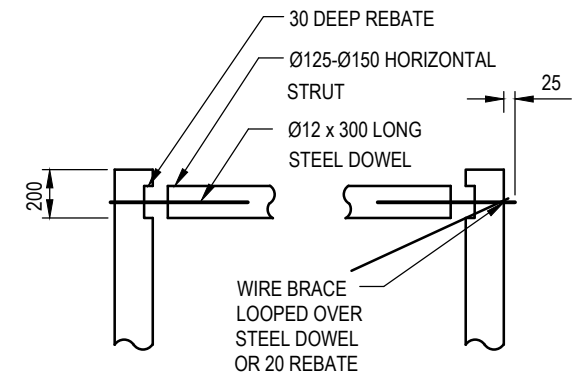

DETAIL 1

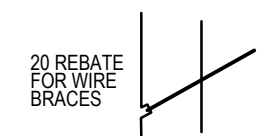

DETAIL 2

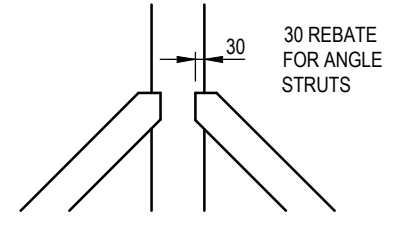

DETAIL 3

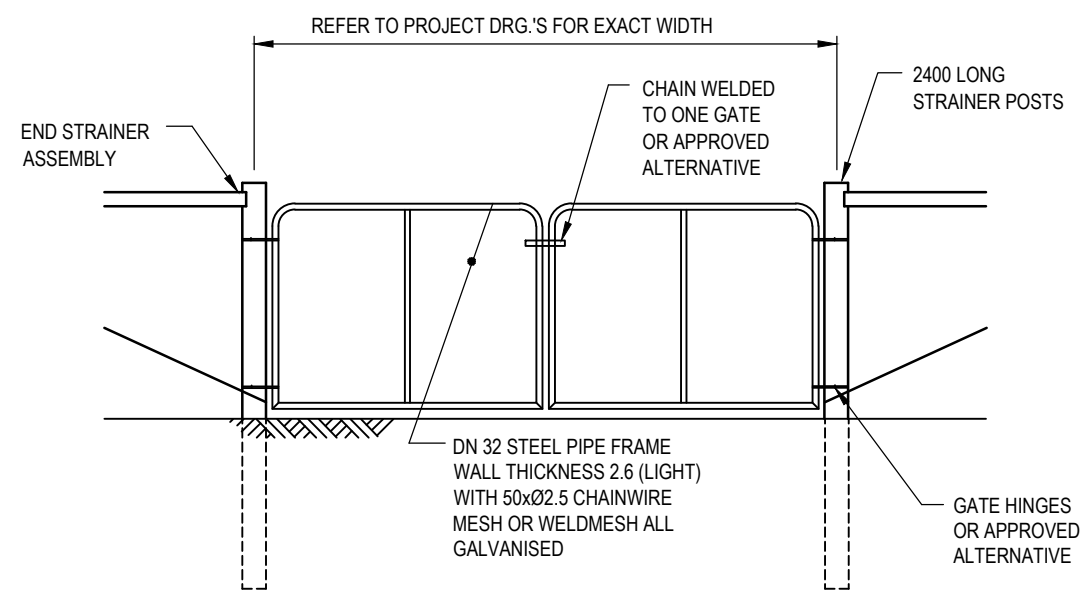

TYPICAL GATE ASSEMBLY
 (2x3000 WIDE GATE)

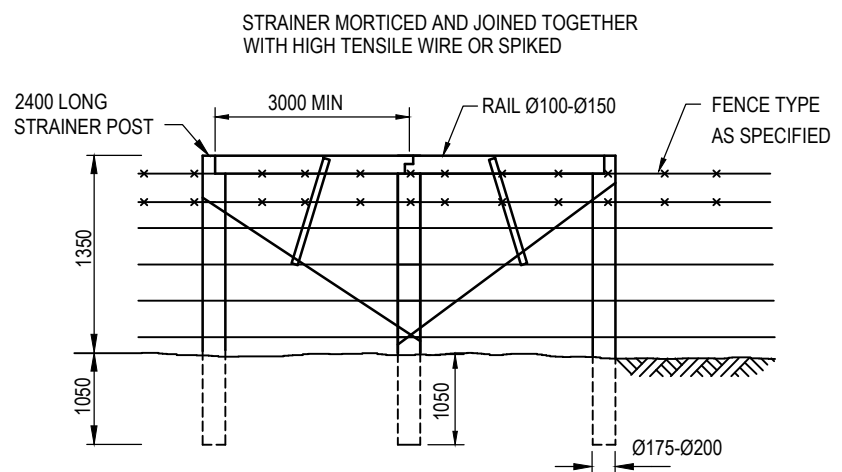

DOUBLE TIMBER BOX STRAINER ASSEMBLY
 USE WHERE THERE IS ANY CHANGE IN DIRECTION OF FENCELINE GREATER THAN 30°

NOTES

- FENCING TO BE SUPPLIED AND INSTALLED IN ACCORDANCE WITH AUSTRALIAN STANDARD AS 1725 AND MAIN ROADS SPECIFICATION 903 FENCING.
- DIMENSIONS SHOWN ON THIS DRAWING ARE TYPICAL.
- POSTS TO BE VERTICAL WITH TOLERANCE 1 : 50.
- TIMBER TO BE TREATED TO H4 IN ACCORDANCE WITH AUSTRALIAN STANDARD AS 1604.1.
- WIRE TO BE TENSIONED BETWEEN PAIRS OF ANCHORAGE POINTS. ANCHORAGE POINTS ARE TO BE LOCATED AT ALL CHANGES IN FENCE DIRECTION AND AT SPACING NO GREATER THAN 200m.
- POSTS TO BE BURIED OR DRIVEN TO DEPTHS AS SHOWN UNLESS OTHERWISE SPECIFIED.
- STRAINER POSTS TO BE USED IN LIEU OF FENCE POSTS WHERE SHOWN ON FENCING LAYOUT DRAWINGS AND WHERE INSTRUCTED BY THE SUPERINTENDENT.
- POSTS TO BE EQUALLY SPACED BETWEEN CHANGES IN FENCE DIRECTION WITH CENTRES NOT EXCEEDING 10m EXCEPT WITH END STRAINER ASSEMBLY.
- END STRAINERS SHALL BE OFFSET SO THE FENCE WIRES FOLLOW A STRAIGHT LINE.
- DIAGONAL WIRE BRACE STRANDS TO BE TENSIONED BY INSERTING A LENGTH OF STEEL PIPE (OR STAR PICKET) AND ROTATING ABOUT THE STRANDS. THE OUTER END OF THE PIPE SHALL BE PROPPED BEHIND THE HORIZONTAL STRUT ONCE THE STRANDS ARE FULLY TENSIONED. BOTH ENDS OF THE PIPE TO BE SECURED WITH WIRE TIES.
- ALL UNITS ARE IN MILLIMETRES UNLESS OTHERWISE NOTED.

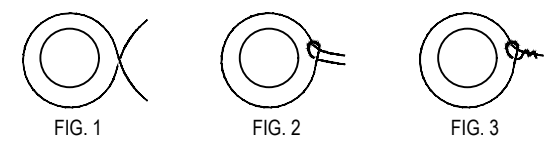

METHOD OF TYING OFF AT STRAINER ASSEMBLIES

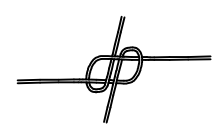

METHOD OF JOINING WIRES
 (OR APPROVED ALTERNATIVE)

REFERENCE DRAWINGS	
AGRICULTURAL FENCING DETAILS	200331-0096
PREFABRICATED FENCEWIRE DETAILS	200331-0097
PLAIN FENCEWIRE DETAILS	200331-0098



No.	DESCRIPTION	APPROVED & DATE
1	TITLE BLOCK & FILE No. UPDATED	A.Wong 26/10/23
AMENDMENTS		

<p>PLANNING AND TECHNICAL SERVICES DIRECTORATE ROAD AND TRAFFIC ENGINEERING BRANCH Waterloo Crescent Telephone 138 138</p>	DRAWN	RTE BRANCH
	DESIGNED	M. VASEV 14.06.05
	VERIFIED	J. KARPINSKI 14.06.05
	APPROVED	W. CANNELL 15.06.05
	FILE NO.	13/4330

STANDARD DRAWING	
FENCING	
TIMBER STRAINER AND POST DETAILS	
MRWA DRAWING NUMBER	200331-0101-1
AMENDMENT	

NOT TO SCALE
 SCALES
 A3