

METHOD OF TYING OFF AT STRAINER ASSEMBLIES

10 GAUGE TIE WIRE USED TO HOLD THE WIRE STRANDS IN VERTICAL POSITION ONLY AND SHALL ALLOW FOR HORIZONTAL MOVEMENT

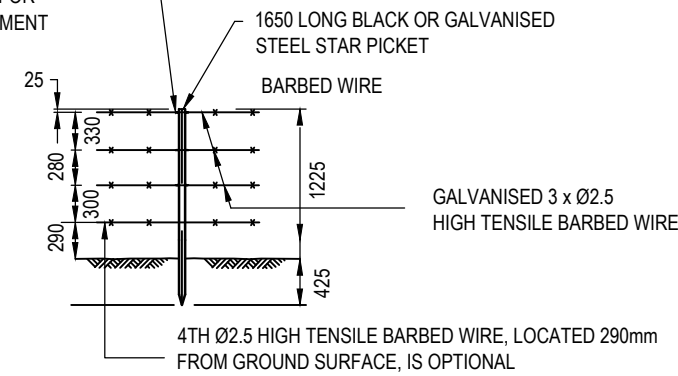

POST DETAIL AND WIRE STRAND SPACING

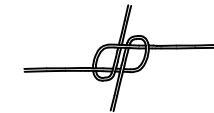

METHOD OF JOINING WIRES (OR APPROVED ALTERNATIVE)

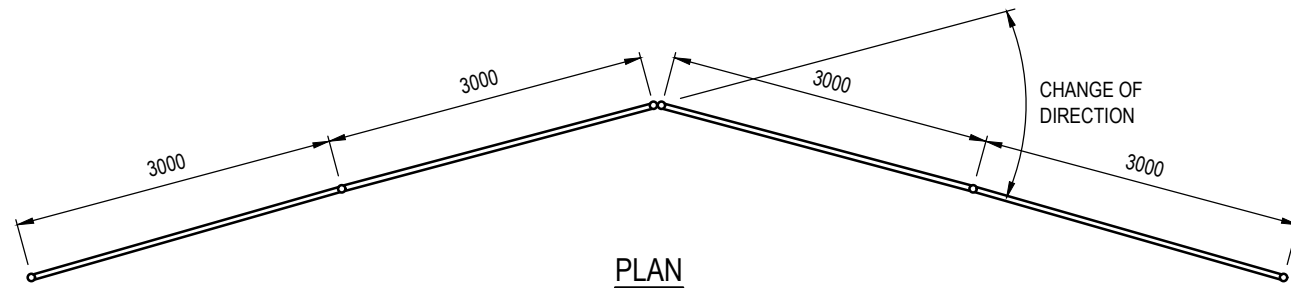

PLAN

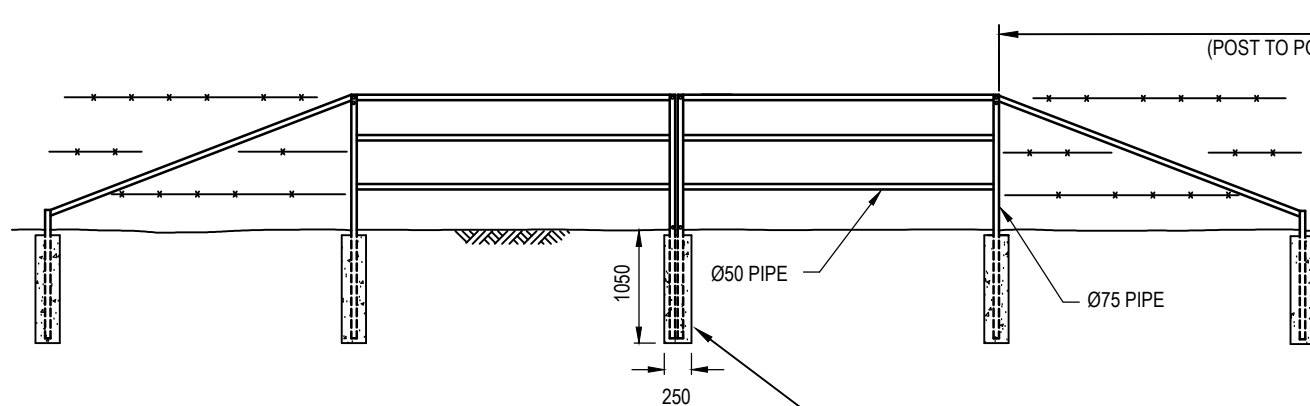

ELEVATION ANGLE STRAINER ASSEMBLY

AT CHANGES OF DIRECTION
REFER TO END STRAINER ASSEMBLY FOR OTHER DETAILS

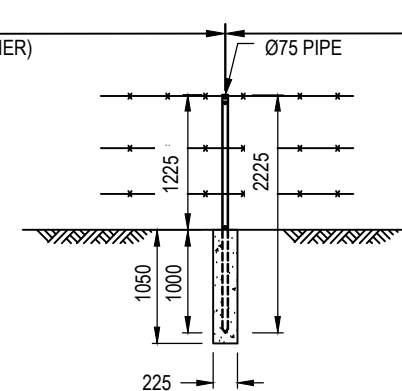

SINGLE STRAINER ASSEMBLY

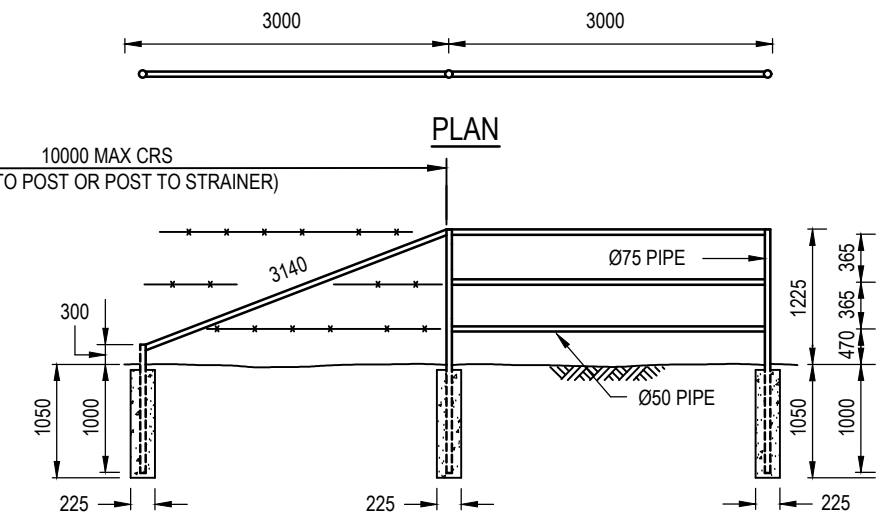

ELEVATION END STRAINER ASSEMBLY

AT END OF FENCE

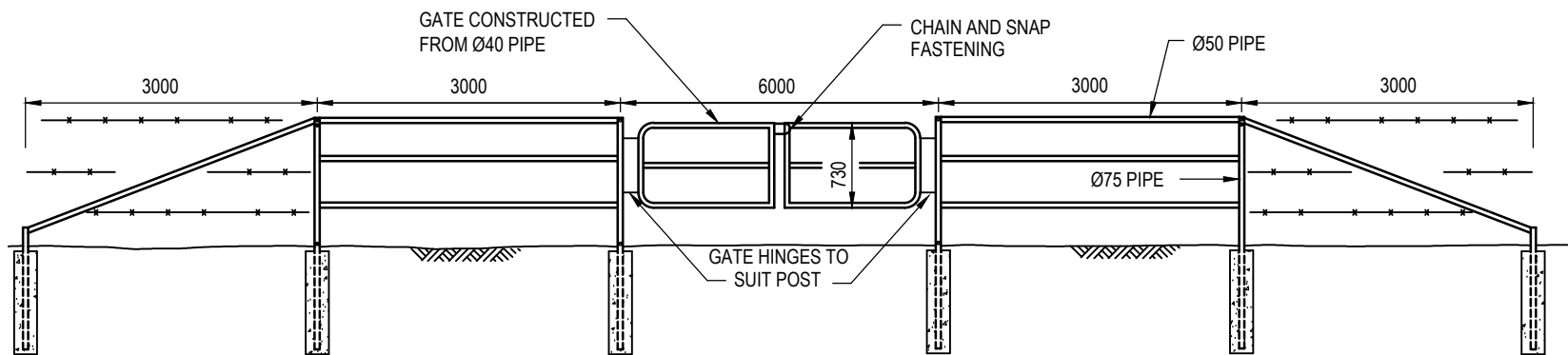

GATE STRAINER ASSEMBLY

(2 OF WITH GATE SHOWN)
REFER TO END STRAINER ASSEMBLY FOR OTHER DETAILS

NOTES

- FENCING TO BE SUPPLIED AND INSTALLED IN ACCORDANCE WITH AUSTRALIAN STANDARD AS 1725 AND MAIN ROADS SPECIFICATION 903 FENCING.
- DIMENSIONS SHOWN ON THIS PLAN ARE TYPICAL.
- STEEL PIPE TO BE IN ACCORDANCE WITH AUSTRALIAN STANDARD AS 1074.
- PIPE MEASUREMENTS SHOWN ARE INSIDE DIAMETER.
- PIPE WALL THICKNESS TO BE 4mm (MEDIUM).
- STRAINER ASSEMBLIES SHALL BE CONSTRUCTED OF 75mm DIA. STEEL UPRIGHTS AND 50mm DIA HORIZONTAL AND DIAGONAL STAYS CAPPED WITH CONCRETE.
- STRAINER ASSEMBLY TO BE AS SHOWN OR APPROVED PREFABRICATED EQUIVALENT.
- IF HOLES FOR INTERMEDIATE STRAINERS OR STEEL STRAINER ASSEMBLIES NEED TO BE DRILLED, THE RESULTANT HOLES MUST BE CONCRETED.
- ON STRAINERS EACH LINE WIRE TO BE WRAPPED AROUND THE STRAINER AND TWISTED AROUND ITSELF TO SECURE.
- POSITION OF STRAINERS AND GATES TO BE AS SPECIFIED IN THE ASSOCIATED FENCING LAYOUT DRAWINGS AND WHERE INSTRUCTED BY THE SUPERINTENDENT.
- GALVANISED STAR PICKETS TO BE IN ACCORDANCE WITH AUSTRALIAN STANDARD AS 4680 AND 4792.
- GALVANISED WIRE TO BE IN ACCORDANCE WITH AUSTRALIAN STANDARD AS 4534.
- BARBED WIRES TO BE SECURED BY PREFORMED CLIPS OR WIRE TIES AT EACH LINE STEEL POST.
- WIRE SHOULD BE ATTACHED TO THE PROPERTY SIDE OF THE POSTS.
- WIRE TO BE TENSIONED TO MANUFACTURER'S SPECIFICATIONS.
- POSTS TO BE VERTICAL WITH TOLERANCE 1:50
- POSTS TO BE BURIED OR DRIVEN TO DEPTHS AS SHOWN UNLESS OTHERWISE SPECIFIED.
- WIRE TO BE TENSIONED BETWEEN PAIRS OF ANCHORAGE POINTS. ANCHORAGE POINTS TO BE LOCATED AT ALL CHANGES IN FENCE DIRECTION AND AT SPACING NO GREATER THAN 200m.
- DIAL BEFORE DIG PRIOR TO INSTALLATION.
- CONCRETE STRENGTH IN FOOTING 20 MPa.
- ALL UNITS ARE IN MILLIMETRES UNLESS OTHERWISE NOTED.

3

3	TITLE BLOCK & FILE No. UPDATED	A. Wong 26/10/23
2	4th WIRE AMENDED-PROPOSED OPTIONAL, DETAILS OF CONCRETE FOOTINGS NOTES 19-20 ADDED	T. FREEMAN 31.10.2012
1	POST/STRAINER SPACING ADDED, STAR PICKET DETAIL AMENDED + RENAMED, NOTES 16-18 ADDED	C. MAGRIPLIS 16.12.2009
No.	DESCRIPTION	APPROVED & DATE
AMENDMENTS		

PLANNING AND TECHNICAL SERVICES DIRECTORATE
ROAD AND TRAFFIC ENGINEERING BRANCH
Waterloo Crescent
Telephone 138 138
EAST PERTH 6004

DRAWN	RTE BRANCH
DESIGNED	M. VASEV 14.06.05
VERIFIED	J. KARPINSKI 14.06.05
APPROVED	W. CANNELL 15.06.05
FILE NO.	13/4330

STANDARD DRAWING
FENCING
PASTORAL CATTLE FENCE

MRWA DRAWING NUMBER
200331-0099-3

AMENDMENT

NOT TO SCALE
A3