

Next Exits:
 1 Karel Ave
 2 Kwinana Fwy

Next Exits:
 3 Kenwick Link
 4 Orrong Rd/Welshpool Rd East
 5 Tonkin Hwy

- LEGEND**
- AD - Advance Direction Sign
 - ADOL - Advance Direction Sign Overlay
 - ID - Intersection Direction Sign
 - RD - Reassurance Direction Sign
 - AExit - Advance Exit Direction Sign
 - Exit - Exit Direction Sign
 - IS - Interchange Sequence Sign
 - ISOL - Interchange Sequence Sign Overlay
 - END - End of Highway Sign

ROE HIGHWAY STAGE 6 - CONTRACT 112/01
DIRECTION SIGNING STRATEGY

Not to scale. Sign locations are indicative only.

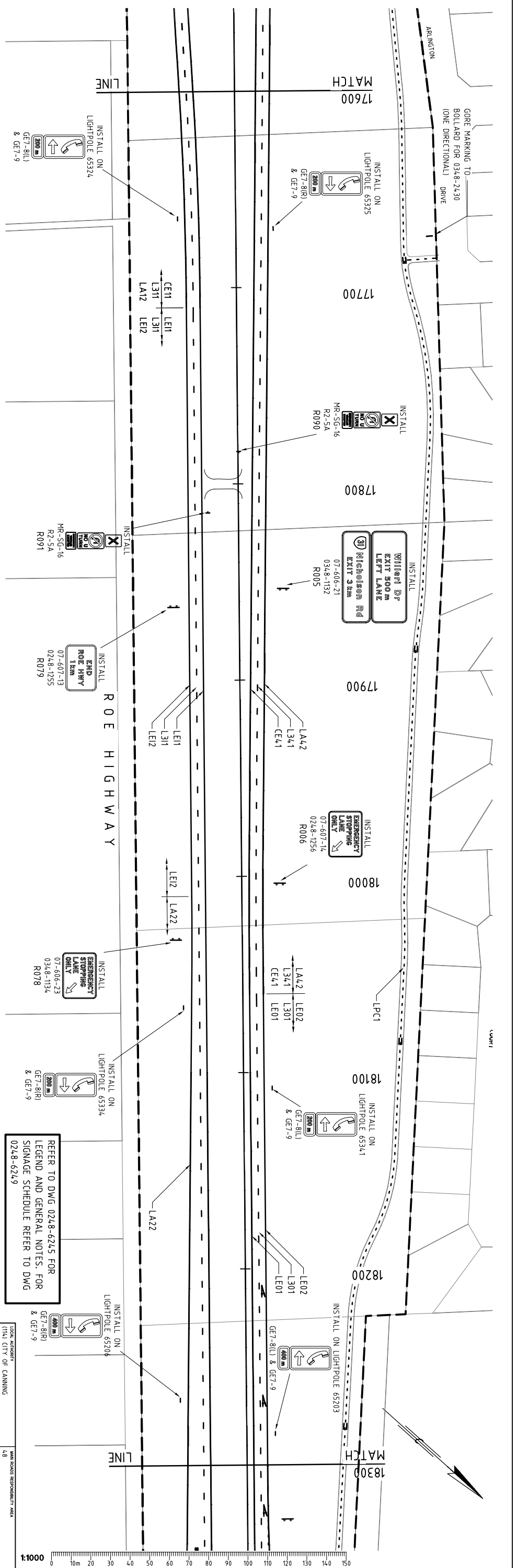
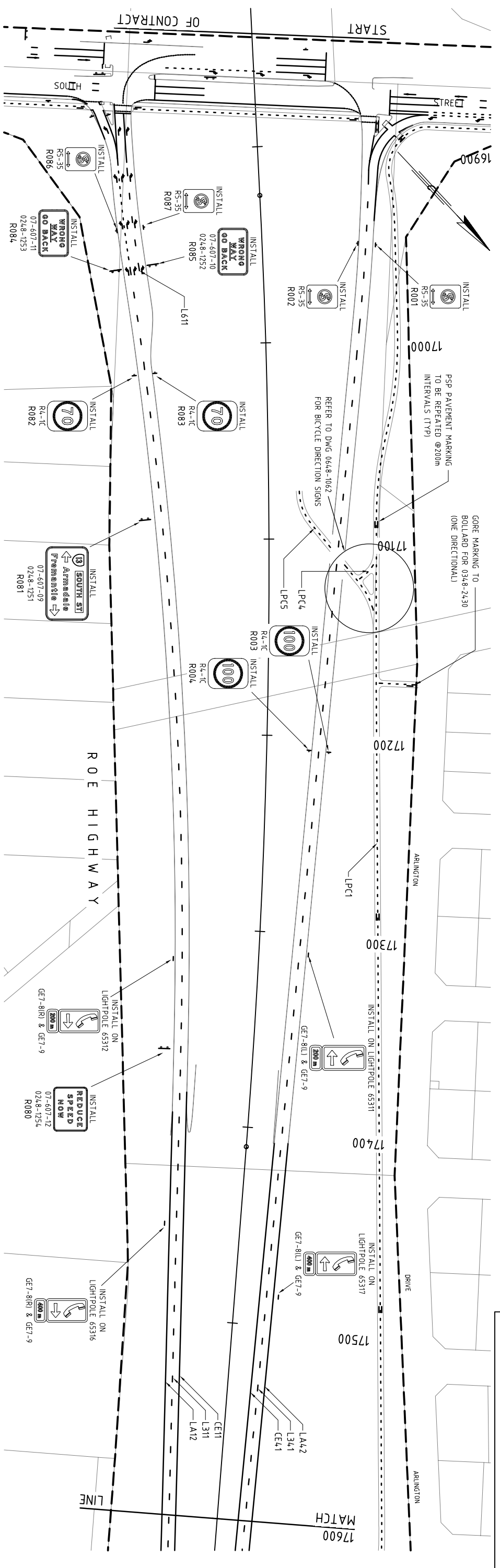

REFER TO DWG 0248-6245 FOR LEGEND AND GENERAL NOTES, FOR SIGNAGE SCHEDULE REFER TO DWG 0248-6249



No.	1	SEPT 07	NOTE REFERRING TO BICYCLE DIRECTION SIGNS ADDED.	DATE	DESCRIPTION
<p>Kellogg Brown & Root Pty Ltd KBR Kellogg Brown & Root Pty Ltd ABN 91 007 660 317 Level 2, Capital Centre, 256 St George's Terrace Perth, Western Australia 6000</p>					
DESIGN		DESIGNED		SCALE	
E. NORONHA		E. NORONHA		SCALE 1:1000	
11/02		11/02			
E. GOHEZ		E. GOHEZ			
11/02		11/02			
J. MOORE		J. MOORE			
07/03		07/03			
J. BOND		J. BOND			
05/01/04		05/01/04			
<p>Government of Western Australia MAJOR PROJECTS DIRECTORATE Western Australia</p>					
<p>Government of Western Australia MAJOR PROJECTS DIRECTORATE Western Australia</p>					
DESIGNED		DESIGNED		DATE	
E. NORONHA		E. NORONHA		06/01/04	
11/02		11/02			
E. GOHEZ		E. GOHEZ			
11/02		11/02			
J. MOORE		J. MOORE			
07/03		07/03			
J. BOND		J. BOND			
05/01/04		05/01/04			
<p>Government of Western Australia MAJOR PROJECTS DIRECTORATE Western Australia</p>					
DESIGNED		DESIGNED		DATE	
L. BAROS		L. BAROS		07/01/04	
07/01/04		07/01/04			
J. GERBARD		J. GERBARD			
07/01/04		07/01/04			
<p>Government of Western Australia MAJOR PROJECTS DIRECTORATE Western Australia</p>					
DRAWING TITLE		DRAWING TITLE		DRAWING NUMBER	
ROE HIGHWAY (H018)		ROE HIGHWAY (H018)		0248-6241-1	
NICHOLSON ROAD TO SOUTH STREET		NICHOLSON ROAD TO SOUTH STREET			
SIGNS AND PAVEMENT MARKINGS		SIGNS AND PAVEMENT MARKINGS			
ROE HIGHWAY - SHEET 1 OF 4		ROE HIGHWAY - SHEET 1 OF 4			
SHEET		SHEET		DRAWING NUMBER	
A1		A1		PEC078-12-C-001	

NOTE: ALL DRAWINGS ARE CONSIDERED UNCONTROLLED UNLESS STAMPED/CONTROLLED COPY IN RED

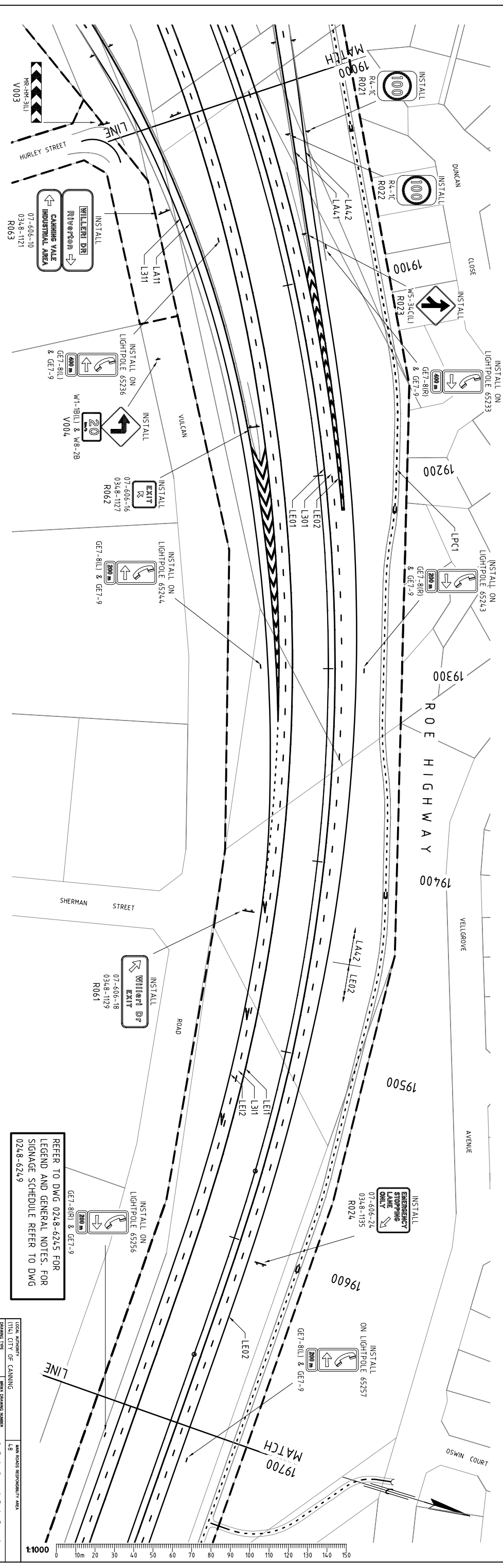
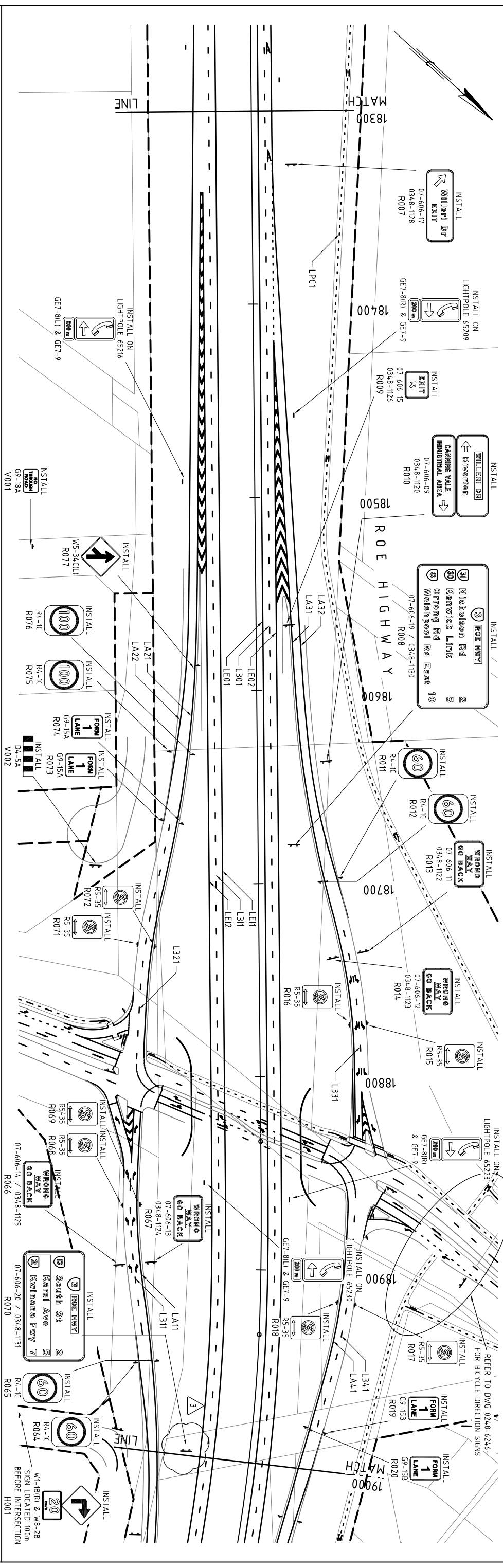

REFER TO DWG 0248-6245 FOR
LEGEND AND GENERAL NOTES. FOR
SIGNAGE SCHEDULE REFER TO DWG
0248-6249

0248-6242-1
DRAWING NUMBER
1141) CITY OF CANNING
DRAWING NUMBER
18
MAIN ROAD SIGNAGE
DRAWING NUMBER
AS CON

No.	1	SEPT 07	NOTE REFERRING TO BICYCLE DIRECTION SIGNS ADDED.	SCALE	SCALE 1:1000		
	DATE		DESCRIPTION		DATE		
<p>Kellogg Brown & Root Pty Ltd KBR Kellogg Brown & Root Pty Ltd ABN 91 007 660 317 Level 2, Capital Centre, 256 St George's Terrace Perth, Western Australia 6000</p>				DESIGN	E. NORONHA	11/02	
					E. GOHEZ	11/02	
				CHECKED	J. MOORE	07/03	
				APPROVED	J. BOND		
				DATE	04/07/03		
				DATE			
				PROJECT MANAGER	D. HOW		
				DATE	12/03/04		
				DIRECTOR	J. GERARD		
				DATE	15/03/04		
				DRAWING STATUS	AS CON		
				SHEET	A1		

NOTE: ALL DRAWINGS ARE CONSIDERED UNCONTROLLED UNLESS STAMPED CONTROLLED COPY IN RED

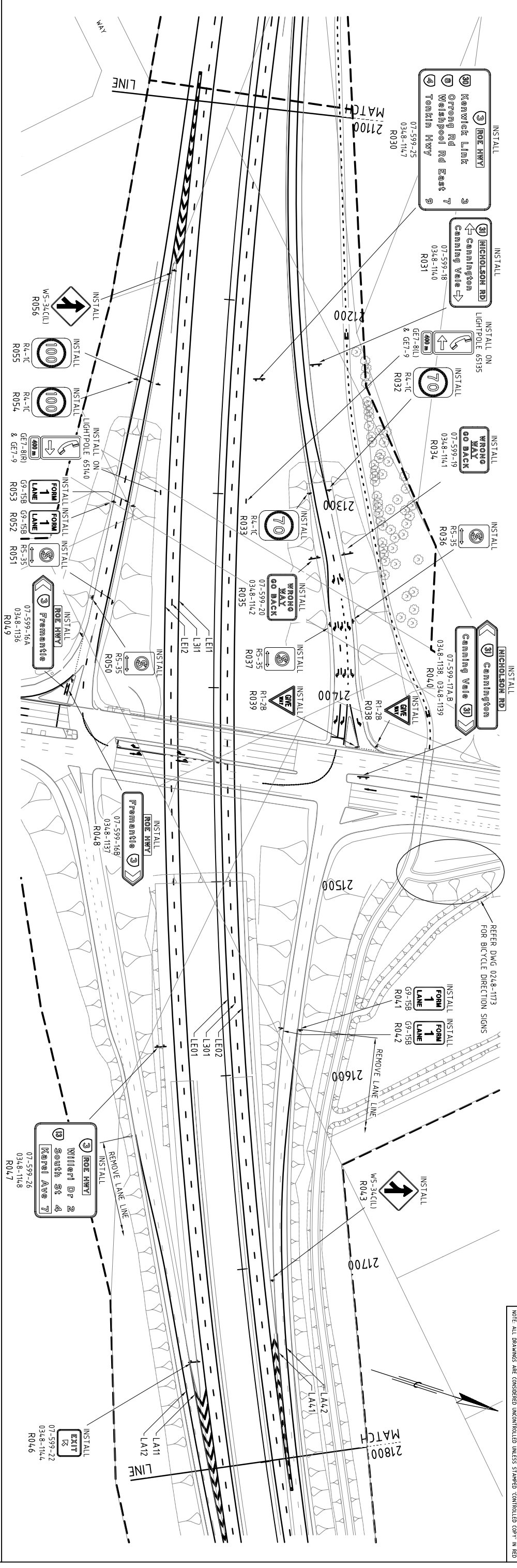

NOTE:
INTERCHANGE SEQUENCE SIGN OVERLAYS
AT ORRONG ROAD ('WILLERI DR 10') AND
KENNICK LINE ('WILLERI DR 6' AND 'SOUTH
ST 8') TO BE REMOVED BY CONTRACTOR

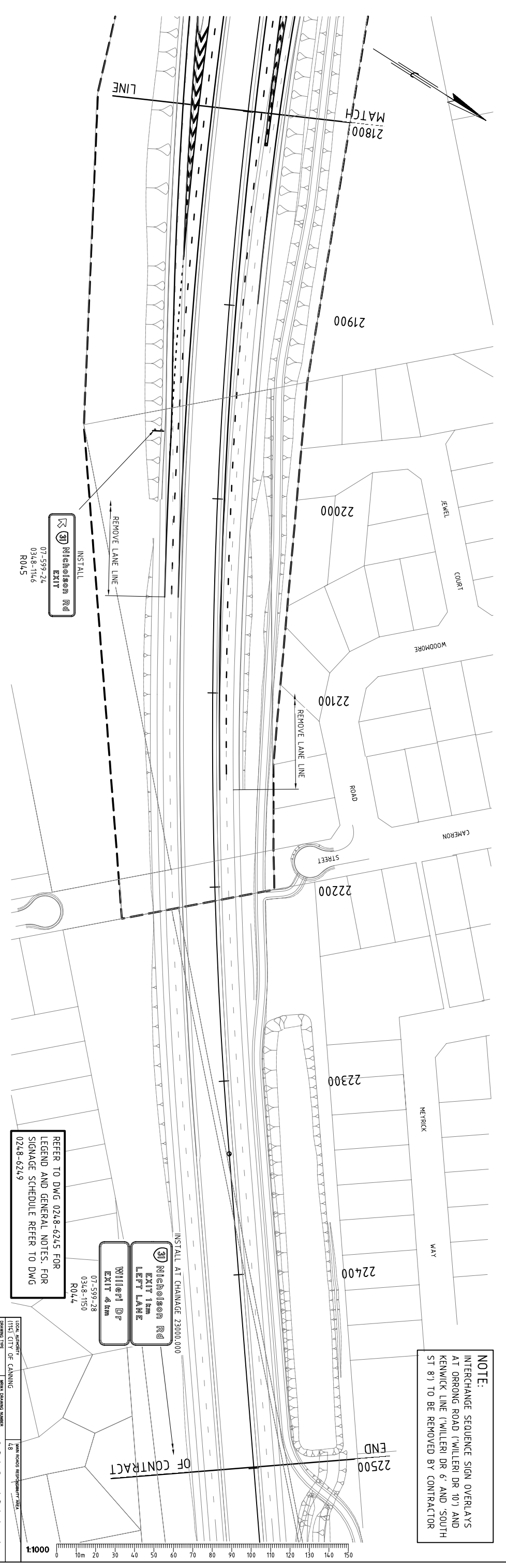

REFER TO DWG 0248-6245 FOR
LEGEND AND GENERAL NOTES. FOR
SIGNAGE SCHEDULE REFER TO DWG
0248-6249

INSTALL AT CHAINAGE 23000.000
NICHOLSON RD
EXIT 1 from
LEFT LANE
WILLERI DR
EXIT 4 from
07-599-28
0348-1750
R044

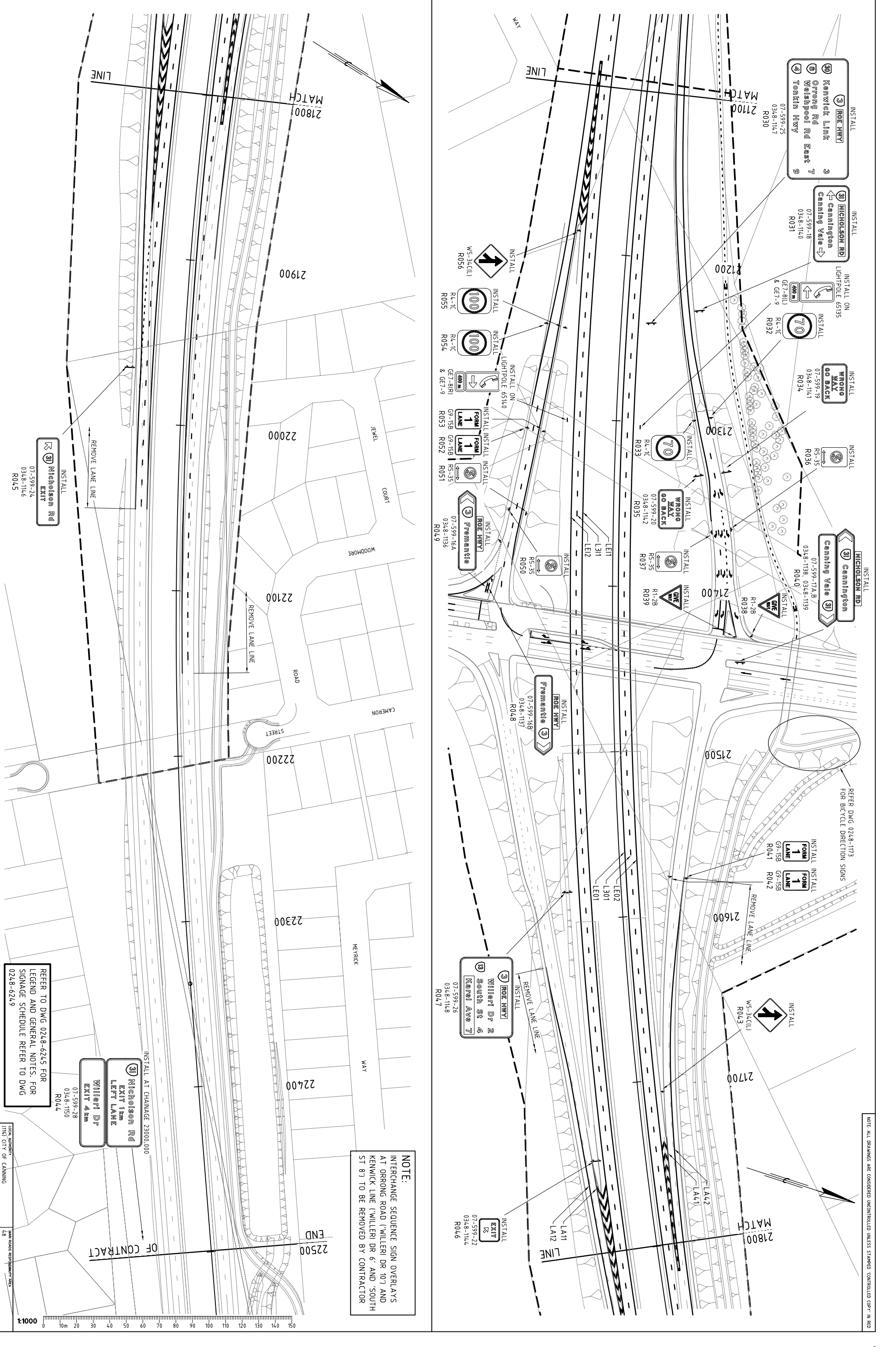

No.	1	SEPT 07	NOTE REFERRING TO BICYCLE DIRECTION SIGNS ADDED.	DESCRIPTION	SCALE	SCALE 1:1000	Kellogg Brown & Root Pty Ltd KBR Kellogg Brown & Root Pty Ltd ABN 91 007 660 317 Level 2, Capital Centre, 256 St George's Terrace Perth, Western Australia 6000	DESIGN E. NORONHA 11/02 CHECKED E. GOHEZ 11/02 APPROVED J. MOORE 07/03 DATE 03/07/03	DESIGN E. NORONHA 11/02 CHECKED E. GOHEZ 11/02 APPROVED J. MOORE 07/03 DATE 03/07/03	PROJECT MANAGER D. HOW DATE 12/03/04	CONTRACTOR L. BAROS PROJECT DIRECTOR J. GERARD DATE 16/03/04	GOVERNMENT OF Western Australia MAJOR PROJECTS DIRECTORATE Western Australia	MAIN ROADS Western Australia	PROJECT TITLE ROE HIGHWAY (H018) NICHOLSON ROAD TO SOUTH STREET SIGNS AND PAYMENT MARKINGS ROE HIGHWAY - SHEET 4 OF 4	DRAWING STATUS AS CON	DRAWING NO. PEC078-12-C-004	SHEET A1
	DATE	DESCRIPTION	SCALE	SCALE 1:1000													

0248-6244-1

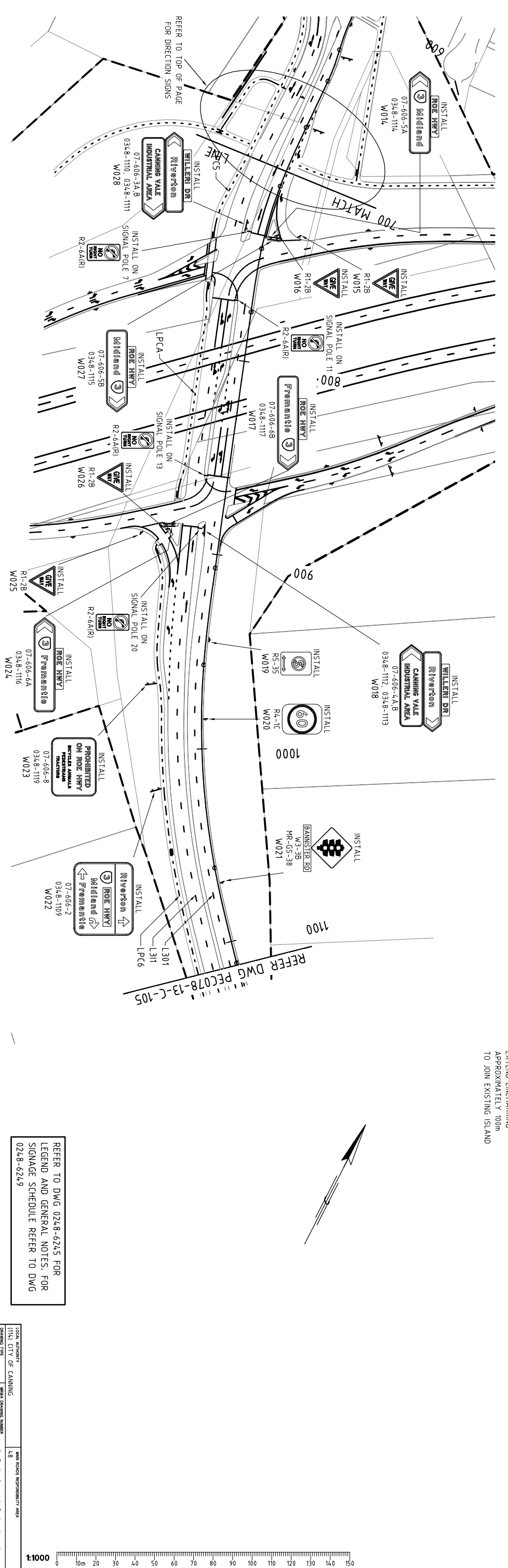
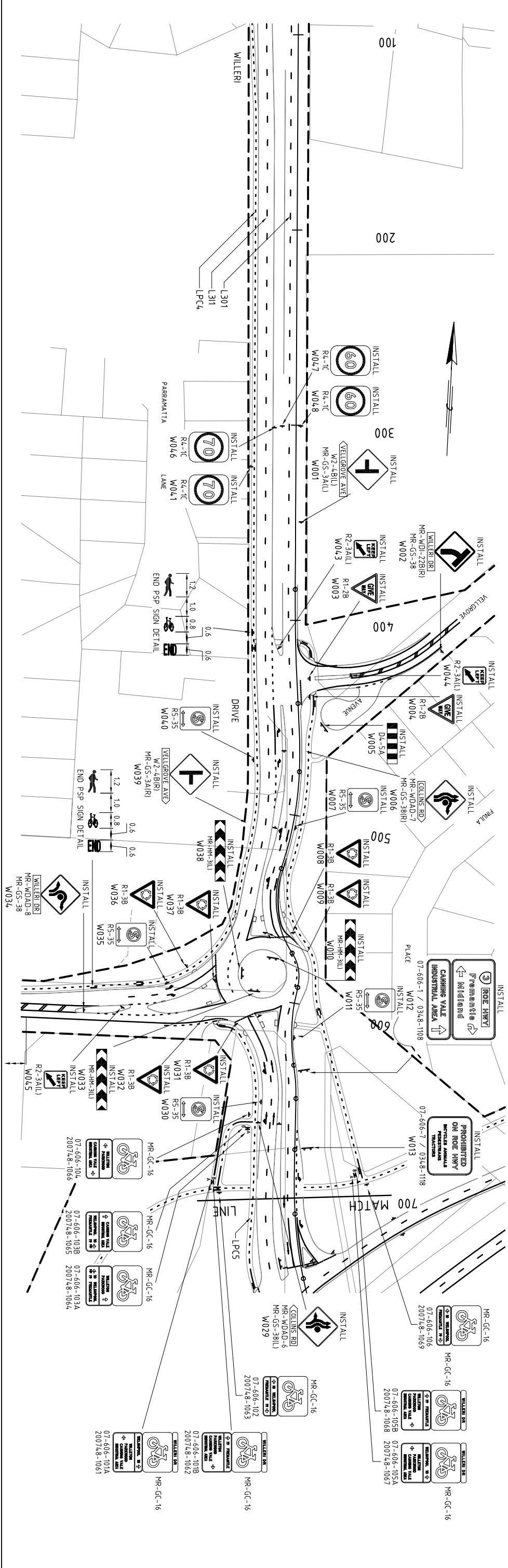

REFER TO DWG 0248-6245 FOR
LEGEND AND GENERAL NOTES. FOR
SIGNAGE SCHEDULE REFER TO DWG
0248-6249

REFER TO DWG 0248-6245 FOR
LEGEND AND GENERAL NOTES. FOR
SIGNAGE SCHEDULE REFER TO DWG
0248-6249

No.	1	SEPT 07	BICYCLE DIRECTION SIGNS ADDED.	SCALE	SCALE 1:1000																			
	DATE	DESCRIPTION																						
<p>Kellogg Brown & Root Pty Ltd KBR Kellogg Brown & Root Pty Ltd ABN 91 007 660 317 Level 2, Capital Centre, 256 St George's Terrace Perth, Western Australia 6000</p>			<table border="1"> <tr> <td>DESIGN</td> <td>E. NORONHA</td> <td>11/02</td> </tr> <tr> <td>DESIGN</td> <td>E. GOHEZ</td> <td>11/02</td> </tr> <tr> <td>CHECKED</td> <td>J. MOORE</td> <td>07/03</td> </tr> <tr> <td>APPROVED</td> <td>J. BOND</td> <td>05/03/04</td> </tr> <tr> <td>DATE</td> <td>DATE</td> <td>DATE</td> </tr> </table>				DESIGN	E. NORONHA	11/02	DESIGN	E. GOHEZ	11/02	CHECKED	J. MOORE	07/03	APPROVED	J. BOND	05/03/04	DATE	DATE	DATE			
DESIGN	E. NORONHA	11/02																						
DESIGN	E. GOHEZ	11/02																						
CHECKED	J. MOORE	07/03																						
APPROVED	J. BOND	05/03/04																						
DATE	DATE	DATE																						
<p>John Holland Macmahon Joint Venture Level 11, 100 Stirling Street Perth, Western Australia 6000</p>			<table border="1"> <tr> <td>PROJECT MANAGER</td> <td>D. HOW</td> <td>DATE</td> <td>05/03/04</td> </tr> <tr> <td>CONTRACT</td> <td>L. BAROS</td> <td>DATE</td> <td>08/03/04</td> </tr> <tr> <td>PROJECT DIRECTOR</td> <td>D. HOW</td> <td>DATE</td> <td>10/03/04</td> </tr> </table>				PROJECT MANAGER	D. HOW	DATE	05/03/04	CONTRACT	L. BAROS	DATE	08/03/04	PROJECT DIRECTOR	D. HOW	DATE	10/03/04						
PROJECT MANAGER	D. HOW	DATE	05/03/04																					
CONTRACT	L. BAROS	DATE	08/03/04																					
PROJECT DIRECTOR	D. HOW	DATE	10/03/04																					
<p>Government of Western Australia MAJOR PROJECTS DIRECTORATE Western Australia</p>			<table border="1"> <tr> <td>LOCAL AUTHORITY</td> <td>WILLERIE</td> </tr> <tr> <td>DRAWING TYPE</td> <td>MAIN ROAD SIGNAGE PLAN</td> </tr> <tr> <td>DRAWING NUMBER</td> <td>6000, 6100</td> </tr> <tr> <td>PROJECT TITLE</td> <td>ROE HIGHWAY (H018)</td> </tr> <tr> <td>DRAWING TITLE</td> <td>NICHOLSON ROAD TO SOUTH STREET</td> </tr> <tr> <td>SIGNAGE AND PAYMENT MARKINGS</td> <td>WILLERIE DRIVE - SHEET 1 OF 1</td> </tr> <tr> <td>SHEET</td> <td>A1</td> </tr> <tr> <td>DRAWING STATUS</td> <td>AS CON</td> </tr> <tr> <td>DRAWING NO.</td> <td>PEC078-12-C-201</td> </tr> </table>				LOCAL AUTHORITY	WILLERIE	DRAWING TYPE	MAIN ROAD SIGNAGE PLAN	DRAWING NUMBER	6000, 6100	PROJECT TITLE	ROE HIGHWAY (H018)	DRAWING TITLE	NICHOLSON ROAD TO SOUTH STREET	SIGNAGE AND PAYMENT MARKINGS	WILLERIE DRIVE - SHEET 1 OF 1	SHEET	A1	DRAWING STATUS	AS CON	DRAWING NO.	PEC078-12-C-201
LOCAL AUTHORITY	WILLERIE																							
DRAWING TYPE	MAIN ROAD SIGNAGE PLAN																							
DRAWING NUMBER	6000, 6100																							
PROJECT TITLE	ROE HIGHWAY (H018)																							
DRAWING TITLE	NICHOLSON ROAD TO SOUTH STREET																							
SIGNAGE AND PAYMENT MARKINGS	WILLERIE DRIVE - SHEET 1 OF 1																							
SHEET	A1																							
DRAWING STATUS	AS CON																							
DRAWING NO.	PEC078-12-C-201																							

