

Albany Ring Road Project

First phase of detours on South Coast Highway and Hanrahan Road / Frenchman Bay Road starting in September 2022

Construction of the major Albany Ring Road interchanges at South Coast Highway and at Hanrahan Road / Frenchman Bay Road will require several significant detours over the next two years. These detours will be implemented in phases and will start in September and continue to mid-2024.

The Albany Ring Road Project will deliver a heavy haulage route around the City of Albany that will allow large freight trucks to bypass the town centre when travelling to and from the Port of Albany.

The Albany Ring Road requires the construction of major interchanges on South Coast Highway and at Hanrahan Road / Frenchman Bay Road.

Significant detours are planned in these locations that will impact east – west traffic movements between Albany and Denmark and along Frenchman Bay Road.

South Coast Highway and Link Road: Detour Phase#1 (September 2022 to December 2022)

A major upgrade to the South Coast Highway and Link Road intersection is currently underway. This will ultimately see a ramp connected to Link Road and the new Albany Ring Road from South Coast Highway and the construction of a bridge over the Albany Ring Road.

To facilitate the works, temporary road closures will be implemented. This will commence with the

temporary closure of Link Road between Lancaster Road and South Coast Highway from September to December 2022. Link Road will remain closed until the connecting ramps for the new interchange are operational which will enable the implementation of the Detour Phase #2. The Phase #2 detour is a significant detour. It is currently being finalised and will be advised in future communications.

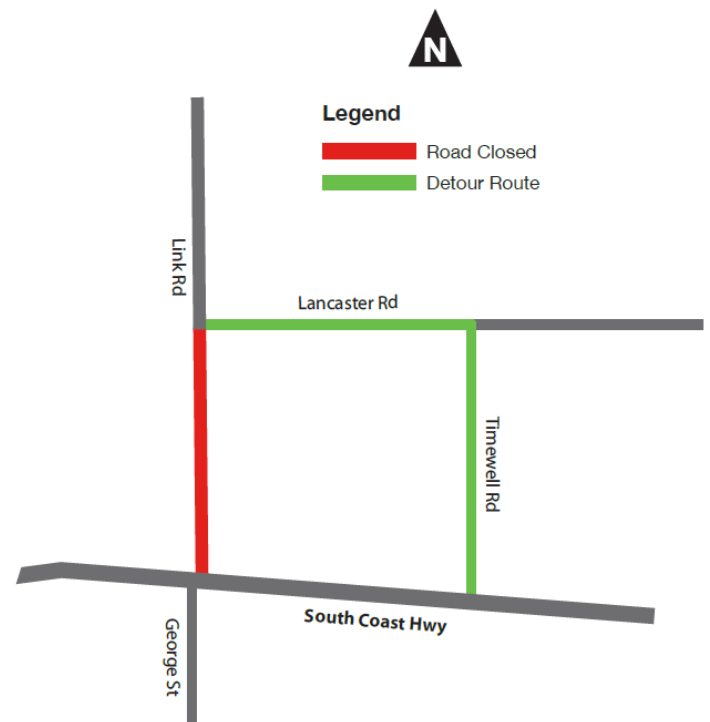
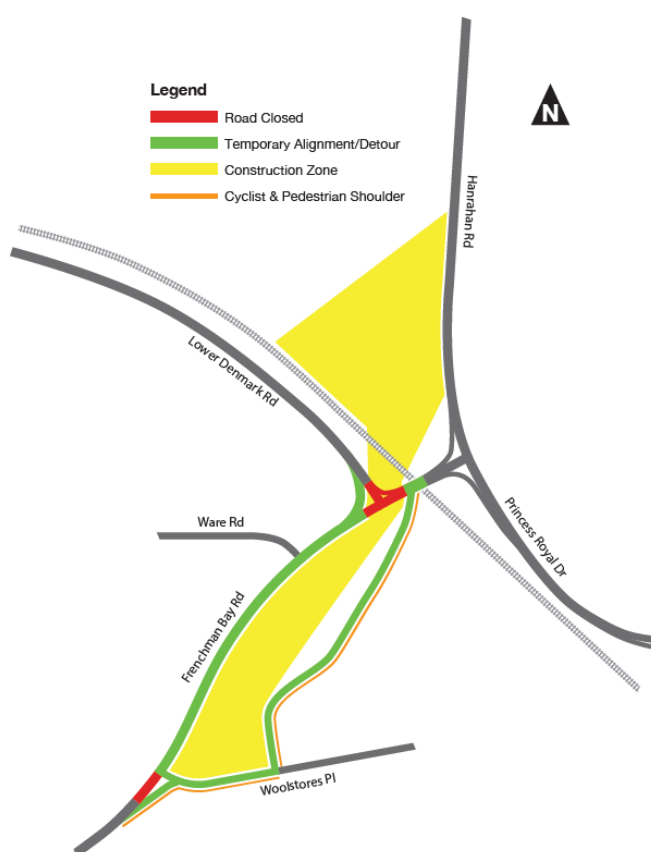

Figure 1: Detour Phase #1 South Coast Highway

Hanrahan Road / Frenchman Bay Road: Detour Phase #1 (December 2022 to 2024)

Detour Phase #1 will be implemented in December 2022 at Hanrahan Road / Frenchman Bay Road to separate road users from construction activities. Access between Lower Denmark Road and Princess Royal Drive / Hanrahan Road for cyclists and road users will be via a loop along Frenchman Bay Road and Woolstores Place.

The detour will be signed, and a sealed two-metre shoulder will be provided for cyclists and pedestrians. The speed limit through the detour will be reduced and road users should allow extra travel time during peak travel periods.



How do I find out more information?

As a part of our communications planning, the project will host several community pop-ups in early November to coincide with the release of information for Phase #2 of the detour at South Coast Highway. The timing, dates and locations will be advised in future communications.

If you haven't already subscribed, the best way to stay up to date with detours is to subscribe to the project's email list – details below.

What does this mean for local residents and businesses?

There may be a temporary increase in traffic on local roads. Please always exercise caution, particularly when reversing from driveways and placing bins for roadside collection.

Adhere to the speed limit and signage throughout the area and allow additional journey time where possible.

Access to businesses will be maintained and signposted during construction.

What this means for road users

During peak periods, additional travel time may be required to pass through the detours. Road conditions may be unfamiliar. Please always proceed with caution and adhere to the speed limit and signage throughout the area.

Further information

If you would like further information, have any questions or concerns our contact details are below.

To stay up to date with the detours, please subscribe to the project's email list by visiting the project's webpage:

www.mainroads.wa.gov.au/albany-ring-road