

2019 Stakeholder and Community Engagement Summary

2019 GOAL

Engage with key stakeholders prior to wider community engagement to understand project requirements. Identify constraints, concerns and opportunities, agree on governance structure, and agree on project objectives.

This process to include:

- Consider and inform core project parameters and requirements.
- Inform the design development process.
- Understand stakeholder needs and expectations.
- Inform the scope finalisation process.

April 20199

- Funding provided to replace Fremantle Traffic bridge to improve safety (road and river), increase rail capacity and efficiency (freight and passenger and improve pedestrian and cycling connectivity over the river.
- Review previous planning and undertake the feasibility and options assessment.

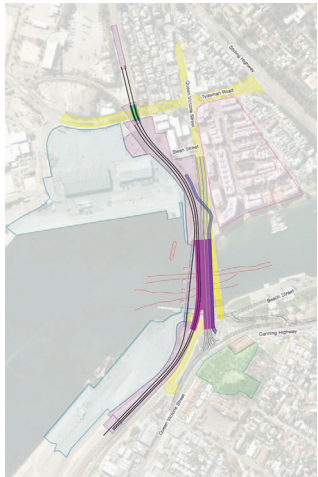

ALIGNMENT 1

2 TRACKS, PSP, 4 LANES



ALIGNMENT 2

1 TRACK, PSP, 4 LANES



ALIGNMENT 3

2 TRACKS, PSP, 4 LANES - BASE OPTION



ALIGNMENT 4

2 TRACKS, PSP, 4 LANES ON CURRENT FTB ALIGNMENT

What We Heard

- Over 100 design requirements, assessment criteria and opportunities identified through individual stakeholder meetings and combined workshop.
- Key interests: planning, heritage, environment and engagement.
- Establish heritage development process.

DECISION

Nine options were considered by stakeholders with three options shortlisted. By the end of 2019, Alignment 3 option was preferred.

2020 Stakeholder and Community Engagement Summary

2020 GOAL

Continue stakeholder engagement to progress the preferred Alignment Option 3 from 2019. Prepare for wider community engagement focusing on generating an understanding of the technical constraints and challenges in the project area.

KEY ACTIONS

- Commence urban and landscaping design planning.
- Commence Working Group meetings.
- Regular local government meetings and briefings.

Consultation continued with key stakeholders to further progress the design. Several meetings were held with three Working Groups: Heritage, Movement and Place; River Operations; and Communications. These groups helped establish the framework required for preparation of the Architecture and Urban Landscaping Design Framework. The following images were shared with stakeholders to illustrate how their feedback had been included (from 2019).

The State Design Review Panel was not supportive of the preferred option as there was not enough community and Traditional Owner support.

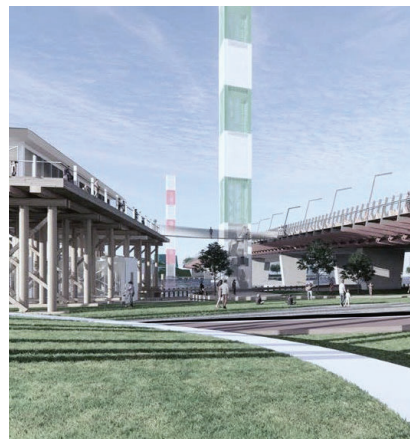

COMMUNITY INPUT INTO PRELIMINARY DESIGN VISION:

To create new infrastructure designed to improve connectivity, amenity and celebrate the crossings, connections, and river transitions of the

Swan River/Derbal Yerrigan at Fremantle/Walyalup. Community consultation started in August, with the following activities:



23,000
Project newsletters posted via letterbox



6
Project updates sent **1230** times to project subscribers



140 people
Attended drop in sessions



300 people
Responded to MySayTransport Survey

Community and Stakeholder Feedback

Differing community views around the preferred location of the bridges resulted in two community and stakeholder representative forums in October and November. Options assessed in 2019 and the option provided by the City of Fremantle were assessed. The outcomes were:

- Project to determine how best to manage increasing freight to and from Port using rail and not trucks on road network.
- Restricting Port operations or shutting down passenger rail services for long periods of time is not feasible.
- How best can the heritage of the traffic bridge be preserved.
- How people ride, walk and connect from one side of the river to the other is important.
- Place making: exciting opportunity to facilitate more use of the river and foreshore by local tourists. Amenity is a key point to be considered through the next stages of design.

Outcomes

General support for the project to continue to the next stage – award a contract to an Alliance team to continue project development only if a commitment could be made by Government to continue community consultation to investigate the best location for the bridges with due consideration given to heritage, movement, and place.

DECISION

Alliance to investigate alignment options and seek community feedback.

2021

Stakeholder and Community Engagement Summary

2021 GOAL

The Alliance to undertake a high-level design process to determine four potential bridge alignment options and present these options to community and key stakeholders through a comprehensive consultation program to understand community preference on a bridge alignment

Four different alignment options were produced, and community consultation commenced to determine alignment option preferences. Consultation sessions, surveys and key stakeholder interactions resulted in a positive response to Option 1. Design consultation in August resulted in Connections, Community and Country themes.



OPTION 1
BETWEEN THE BRIDGES, 2 RAIL TRACKS



OPTION 2
BETWEEN THE BRIDGES, 1 RAIL TRACK



OPTION 3
2 RAIL TRACKS BETWEEN THE BRIDGES,
NEW TRAFFIC BRIDGE EAST



OPTION 4
2 RAIL TRACKS BETWEEN THE BRIDGES,
NEW TRAFFIC BRIDGE ON EXISTING ALIGNMENT

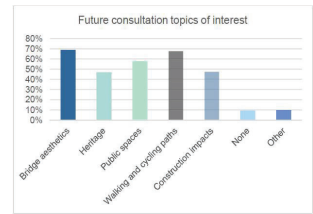
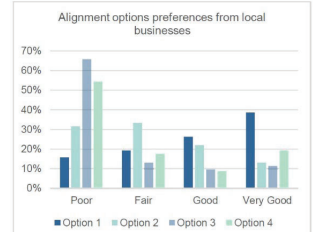
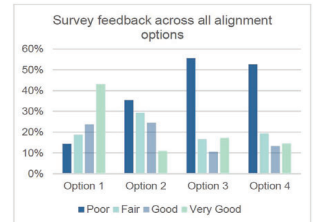

COMMUNITY CONSULTATION:

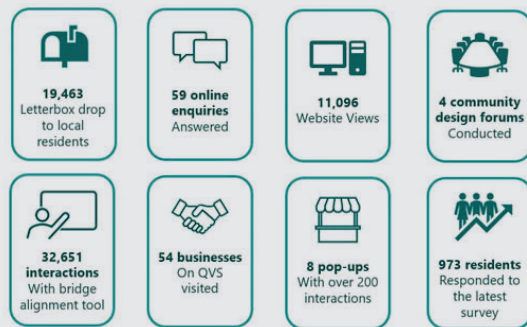

Community Feedback

The community feedback showed option 1 as the preferred alignment to build the new traffic bridge and new rail bridge between the existing traffic bridge and rail bridge.

Key Stakeholder Feedback

- Key stakeholders highlighted issues to help inform future activities and next steps for Fremantle.
- Requests included public space activation on both the north and south riverbanks and to explore opportunities to activate and improve access in the area near the Naval Store.
- Broad stakeholder support for bridge alignment.

Outcomes

- Design progressed on option.
- Further investigation revealed a western alignment could not retain the current intersection.
- Key stakeholders then challenged the design, in particular the integration of place outcomes.

DECISION

Key stakeholders requested the Alliance explore integration of place.

2022 Stakeholder and Community Engagement Summary

2022 GOAL

Alliance to reconsider southern landing area to provide connectivity from Cantonment Hill to the foreshore and deliver an innovative solution for the entry into Fremantle. Engage with community and key stakeholders to seek feedback on concept design announced in August 2022.

The Alliance investigate multiple options with the three most feasible options presented to key stakeholders



QUEEN VICTORIA PRIORITY



CANNING TRENCH

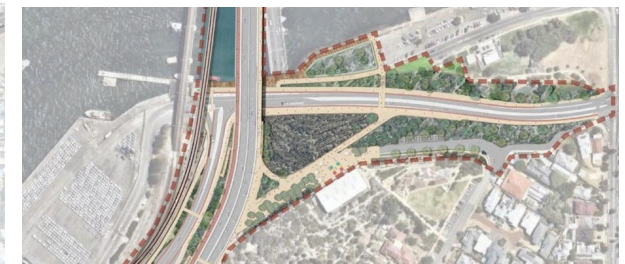

CANNING REALIGNMENT

SENTIMENT SURVEY
SEPTEMBER 2022

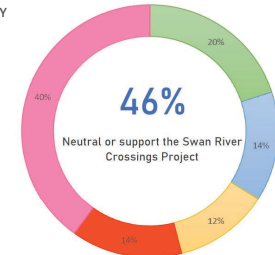

Supports a great deal Somewhat supportive Neutral Somewhat unsupportive Don't support it at all

COMMUNITY CONSULTATION ON PREFERRED OPTION

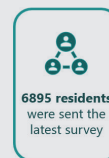
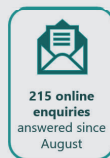

Community Feedback

- There will be more traffic and more congestion.
- Do not move Canning Highway closer to the foreshore.
- The highway closer to the river will destroy the natural environment around the foreshore.
- Increased urban space is an important community value.
- Incorporate art and culture into the new design.
- Better pedestrian and cyclist connectivity to and from Cantonment Hill.

Key Stakeholder Feedback

Preferred option was Canning realignment and new concept was released on 21 August 2022.

- Whadjuk Elders expressed strong value in the connectivity from Cantonment Hill to the river. Less piers in the water allows the songlines to flow along the river.
- Design ticks all the boxes, this is a rare opportunity where the road reserve is provided back to the community for positive urban outcome.

- Coherent entry into Fremantle, with connectivity to the foreshore and Cantonment Hill.
- Supported landscaping opportunities and creation of civic space for community use.
- The wave form bridge design is elegant and refined.
- Design supports both place and movement.

Outcomes

Key stakeholders requested that the alliance share more information on the options to the community for engagement, discussion, and feedback.

DECISION

Based on stakeholder feedback and community concerns around the new concept design, the Alliance will provide more information to the community on the project journey and key feedback to influence design.