

AMENDMENTS

No.	DATE	DESCRIPTION	APPROVED
1	16.5.00	TITLE AMENDED	R.GROVE
2	17.12.01	AMENDMENTS TO TITLE BLOCK, NOTES, CORNER RADIUS.	D.SULLIVAN
3	10.10.17	RETROREFLECTIVE CLASS & TEXT STYLE CHANGED, NOTE & ADDED.	<i>R. Grove</i> 15/10/18

ARROW DETAIL

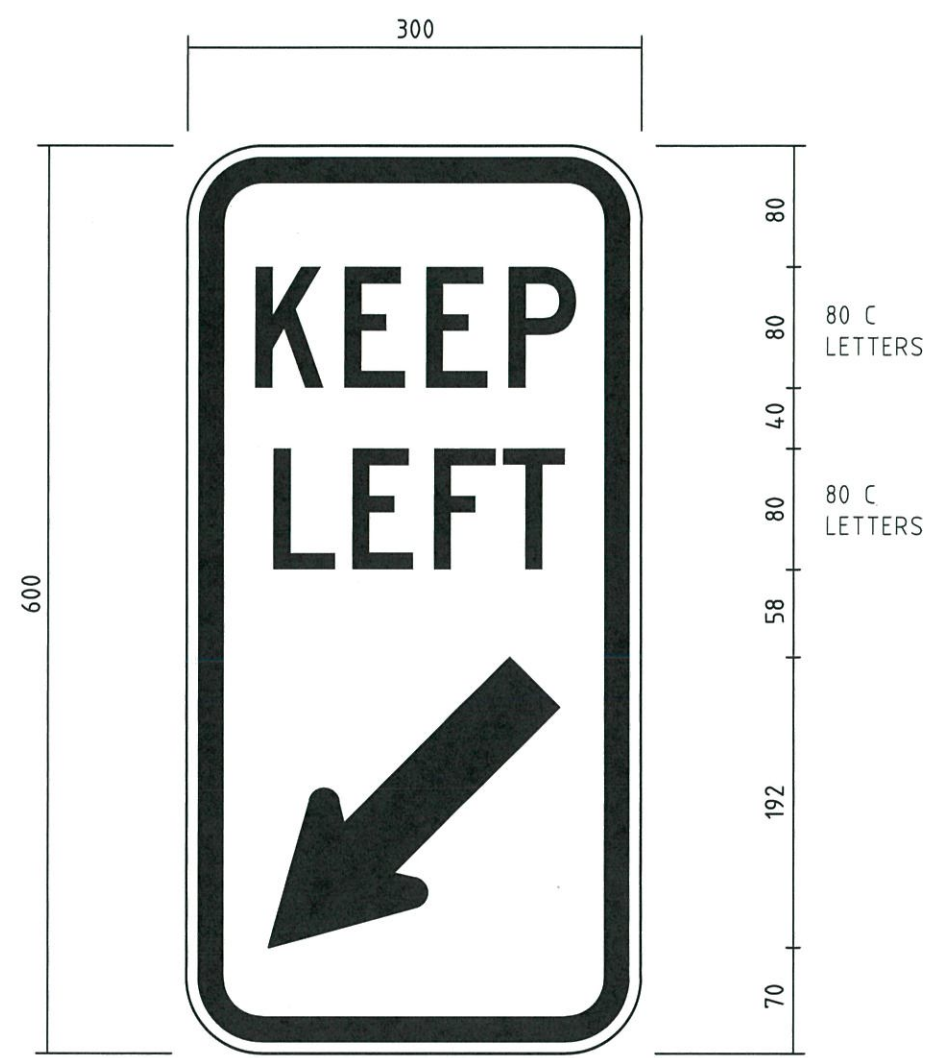
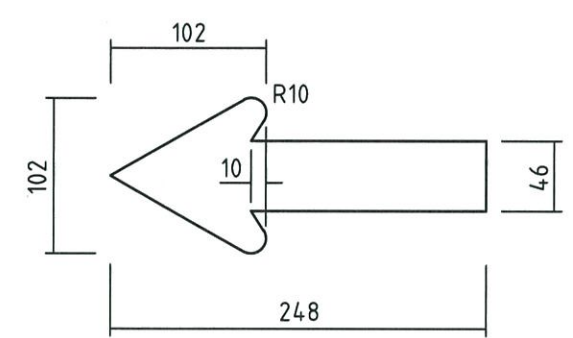

44	212	44
=	193	=
54	192	54

NOTES:

- DIMENSIONS: MEASUREMENTS IN mm. CORNER RADIUS = 50. BORDER = 16. EDGE STRIP = 8. MAIN SIGN PANEL AREA = 0.18 SQM.
- COLOURS: BLACK LEGEND, ARROW AND BORDER ON WHITE RETROREFLECTIVE BACKGROUND.
- RETROREFLECTIVE CLASS OF MATERIAL: CLASS 400.
- GRAFFITI PROTECTION: TO BE SPECIFIED BY THE DESIGNER IN ACCORDANCE WITH MAIN ROADS GUIDELINES.
- MATERIALS: ALL SIGN MATERIALS AND MANUFACTURE TO BE IN ACCORDANCE WITH MAIN ROADS SPECIFICATION 601.
- TEXT FONT COMPLIES WITH FHWA 2000 SERIES.

**MAIN ROADS WESTERN AUSTRALIA**  
 TECHNOLOGY AND ENVIRONMENT  
 ROAD AND TRAFFIC ENGINEERING  
 Waterloo Crescent  
 East Perth 6004

FILE NUMBER	67-08-4F
DESIGNED / DRAWN	J.VOKE 3.8.98
VERIFIED	K.TURNER 27.1.99
APPROVED	R.GROVE 28.1.99

REGULATORY SIGN  
 DIRECTION SERIES  
 KEEP LEFT (FOR NARROW MEDIAN ISLANDS <1.2m)  
 MR-RD-6

LOCAL AUTHORITY	DRAWING NUMBER	AMEND
6018	9931-0103-3	



SCALE 1:1  
 MICROFILM DATE A 3