

AMENDMENTS

| No. | DATE | DESCRIPTION | APPROVED |
|-----|----------|---|--------------------------------|
| 1 | 16.6.95 | COLOR SPEC. CHANGED | C. WOOLDRIDGE |
| 2 | 18.5.00 | TITLE AMENDED | R. GROVE |
| 3 | 15.01.02 | AMENDMENTS TO TITLE BLOCK, NOTES, CORNER RADIUS, BOLT HOLE SPACING ADDED. | D. SULLIVAN |
| 4 | 16.10.17 | FONT STYLE CHANGED, NOTE 5 & COLOUR ADDED. | <i>[Signature]</i> 20/01/18 |

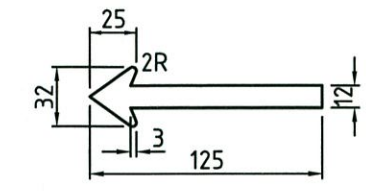

1 (L)

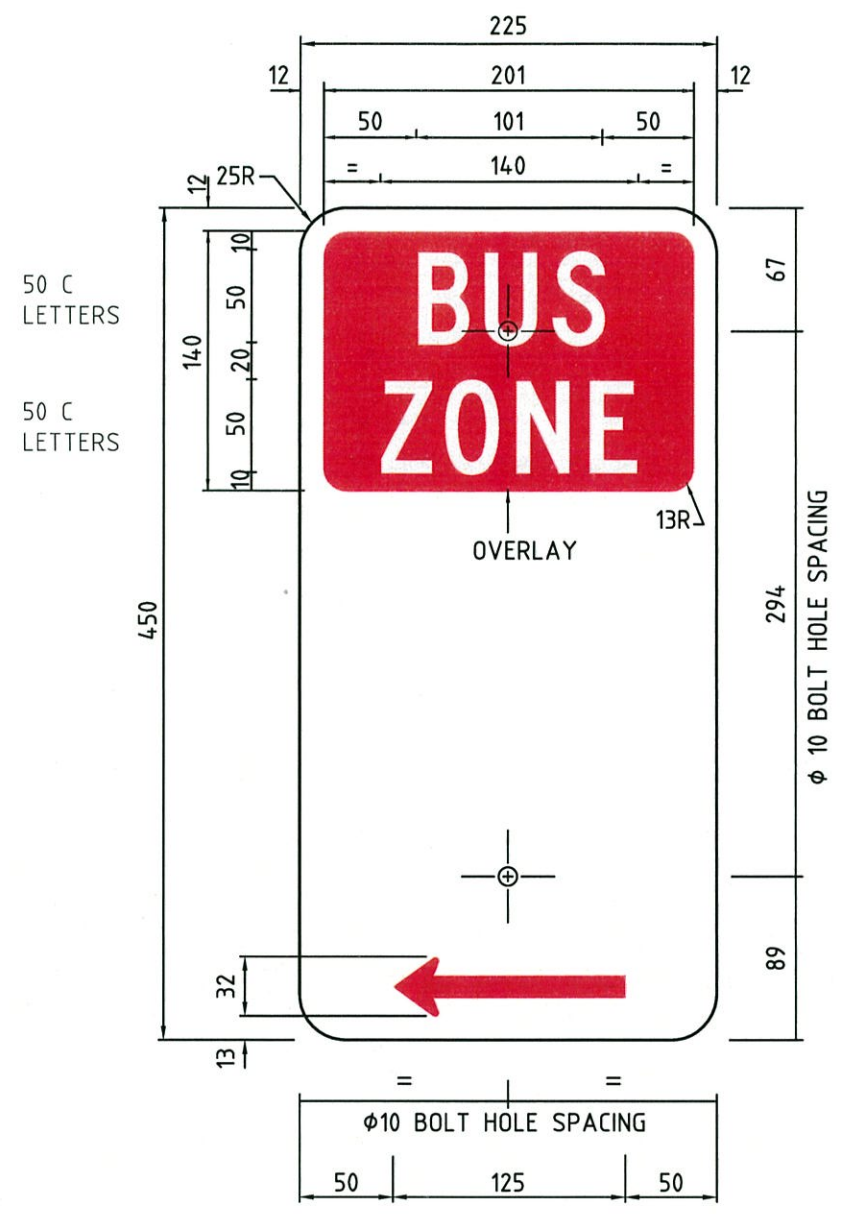
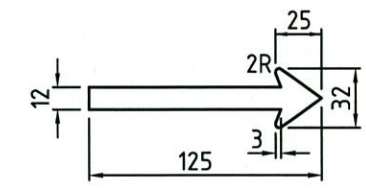

2 (R)

ONLY TO BE USED IN CONJUNCTION WITH OTHER PARKING SIGNS 450mm DEEP

NOTES:

- DIMENSIONS: MEASUREMENTS IN mm. CORNER RADIUS = 25.
MAIN SIGN PANEL AREA = 0.068 SQM.
- COLOURS : PAINTED/SCREENED RED OVERLAY ON WHITE PAINTED BACKGROUND.
- GRAFFITI PROTECTION: TO BE SPECIFIED BY THE DESIGNER IN ACCORDANCE WITH MAIN ROADS GUIDELINES.
- MATERIALS : ALL SIGN MATERIALS AND MANUFACTURE TO BE IN ACCORDANCE WITH MAIN ROADS SPECIFICATION 601.
- TEXT FONTS COMPLY WITH FHWA 2000 SERIES.

MAIN ROADS WESTERN AUSTRALIA
 TECHNOLOGY AND ENVIRONMENT
 ROAD AND TRAFFIC ENGINEERING
 Waterloo Crescent
 East Perth 6004

| | | |
|------------------|---------------|---------|
| FILE NUMBER | 67-08-4F | |
| DESIGNED / DRAWN | C. WOOLDRIDGE | 22.3.95 |
| VERIFIED | T. HAZEBROEK | 22.3.95 |
| APPROVED | R. BROWN | 24.3.95 |

REGULATORY SIGN
 PARKING SERIES
 BUS ZONE
 MR-RPK-6B

| | | |
|-----------------|----------------|-------|
| LOCAL AUTHORITY | DRAWING NUMBER | AMEND |
| 6022 | 9531-1063-4 | |

SCALE 1:4
 MICROFILM DATE
 A 3