

AMENDMENTS			
No.	DATE	DESCRIPTION	APPROVED
1	23.1.12	NOTE 4 AMENDED.	R.KOORENLEVEL 2012
2	1.2.12	TGSI'S ADDED.	R.KOORENLEVEL 2212
3	6.11.13	STOP LINE SET BACK CHANGED FROM 4m TO 5m	R.KOORENLEVEL 6.11.13
4	2.8.16	LEFT TURN POCKET AND COLOUR ADDED.	<i>[Signature]</i>

- NOTES:**
- ALL PAVEMENT MARKING TO INCLUDE REFLECTIVE BEADS.
 - MEDIAN CHEVRON MARKINGS, TRANSVERSE LINES AND SYMBOLS TO BE LONG LIFE THERMOPLASTIC MATERIAL IN ACCORDANCE WITH MRWA SPECIFICATION 604 EXCEPT MATERIAL THICKNESS TO BE 4.5 ± 0.5 MM.
 - BICYCLE PAVEMENT SYMBOLS REFER A.S.1742.9 FIG 3.1.
 - GREEN COLOURED DEMARCATION SURFACE TO BE LONG LIFE MATERIAL WITH A SKID RESISTANCE FACTOR SIMILAR TO THE ROAD SURFACE. IF TWO-PART COLD APPLIED PLASTIC IS USED, INSTALLATION SHALL BE SIMILAR TO THE PRINCIPAL'S METHOD SPECIFICATION FOR THE INSTALLATION OF 40km/h PAVEMENT MARKINGS FOR SCHOOL ZONES (TRIM DOCUMENT No. 07#67301).

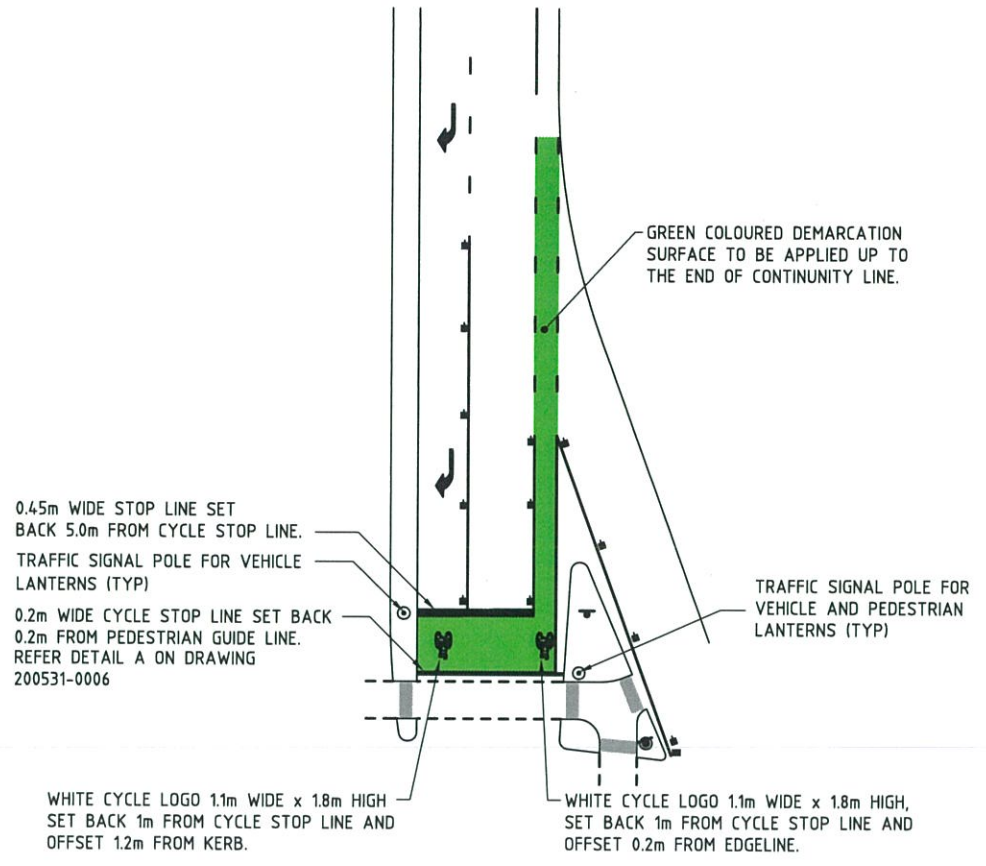

CYCLIST ADVANCE STOP LINE DETAIL FOR APPROACHES WITH CORNER ISLAND
N.T.S.

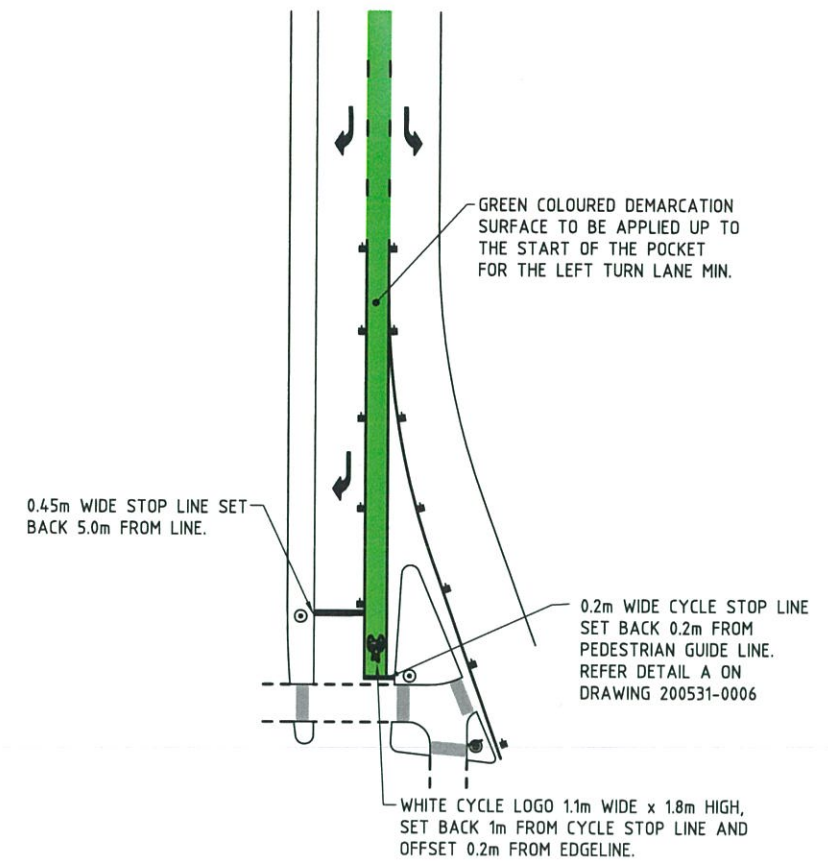

CYCLIST ADVANCE STOP LINE DETAIL FOR TEE JUNCTION APPROACHES
N.T.S.

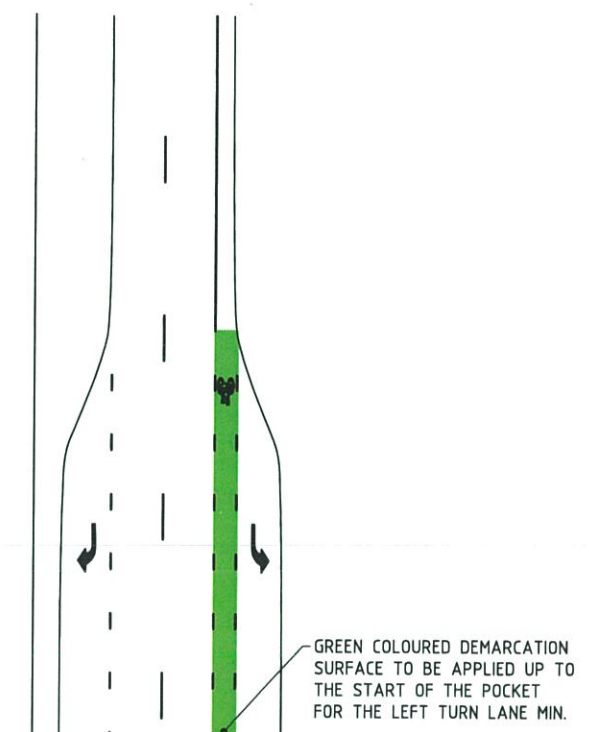

CYCLIST STOP LINE DETAIL FOR APPROACHES WITH CORNER ISLAND AND LEFT TURN POCKET
N.T.S.

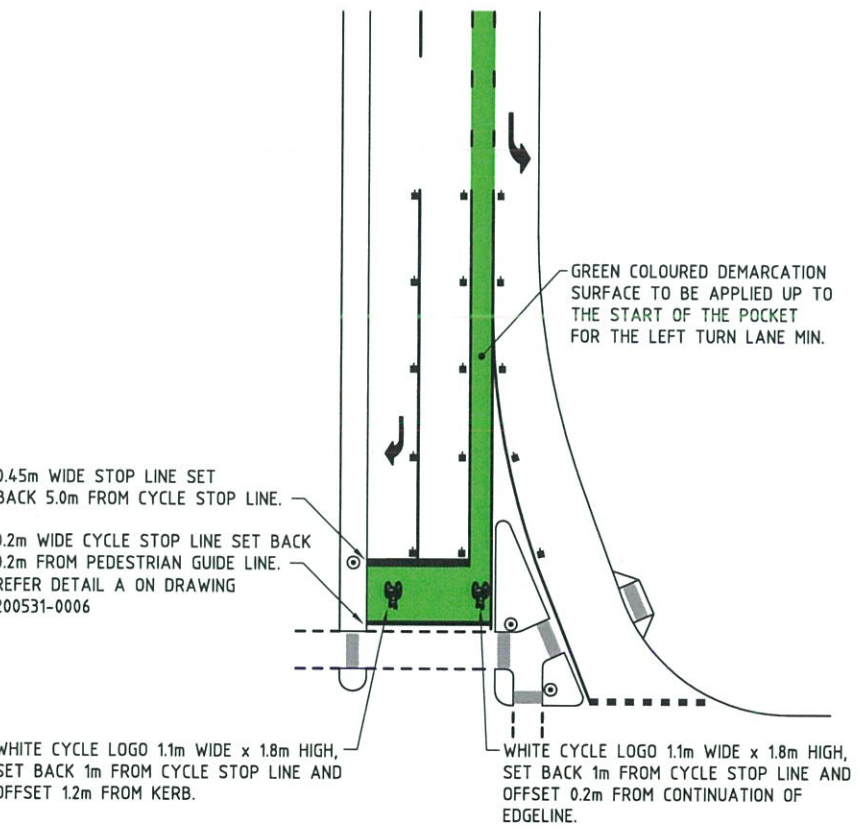

CYCLIST ADVANCE STOP LINE DETAIL FOR APPROACHES WITH CORNER ISLAND AND LEFT TURN LANE
N.T.S.

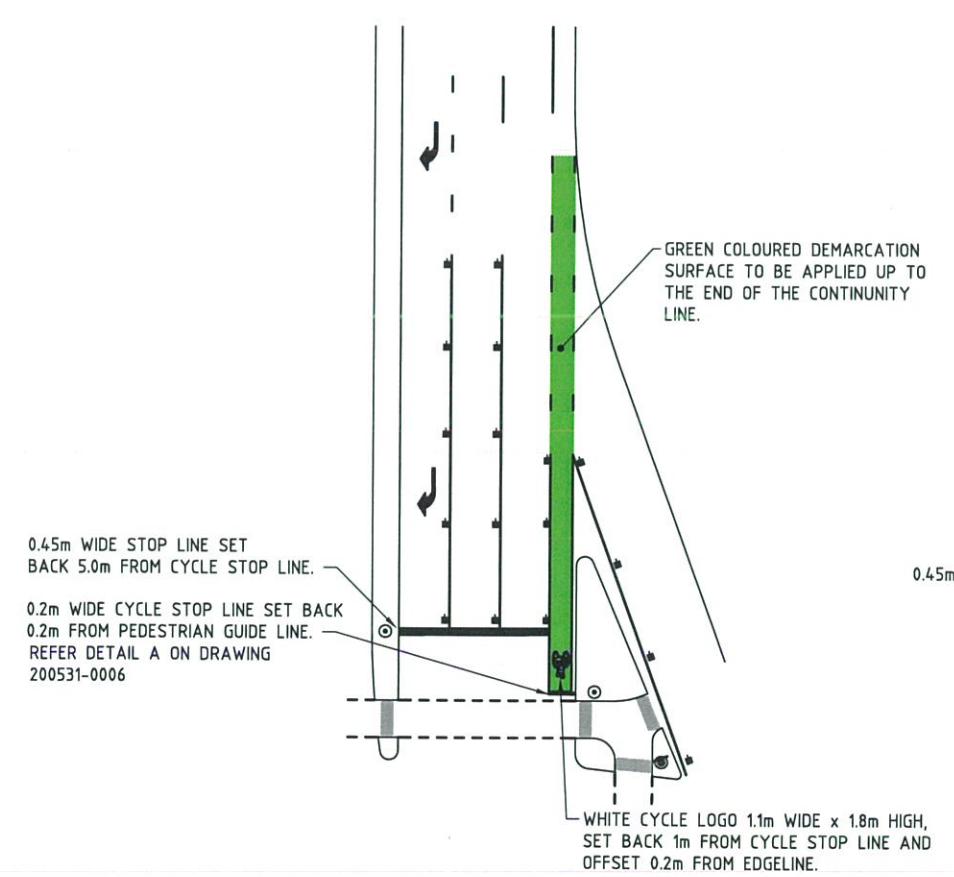

CYCLIST ADVANCE STOP LINE DETAIL FOR APPROACHES WITH TWO THROUGH LANES AND A CORNER ISLAND
N.T.S.

METADATA

GROUND SURVEY STANDARD:
DATE OF CAPTURE:
MAPPING SURVEY STANDARD:
DATE OF CAPTURE:
MAIN ROADS PROJECT ZONE:
HEIGHT DATUM:

Government of Western Australia
MAIN ROADS Western Australia
TECHNOLOGY AND ENVIRONMENT
ROAD AND TRAFFIC ENGINEERING
WATERLOO CRES. EAST PERTH 6004
Telephone (08) 93234111 Fax (08) 93234449

FILE NUMBER: 05/6518
DESIGNED / DRAWN: B SNOOK/E FINDLATER
VERIFIED: D. LANDMARK 14.4.10
APPROVED: R. GROVE 14.4.10

LOCAL AUTHORITY: DRAWING NUMBER: AMENDMENT:

STANDARD DRAWING
CYCLIST ADVANCE STOP LINE DETAILS
SHEET 2 OF 2

200531-0007-4

SCALE: N.T.S.
MICROFILM DATE: A 1