

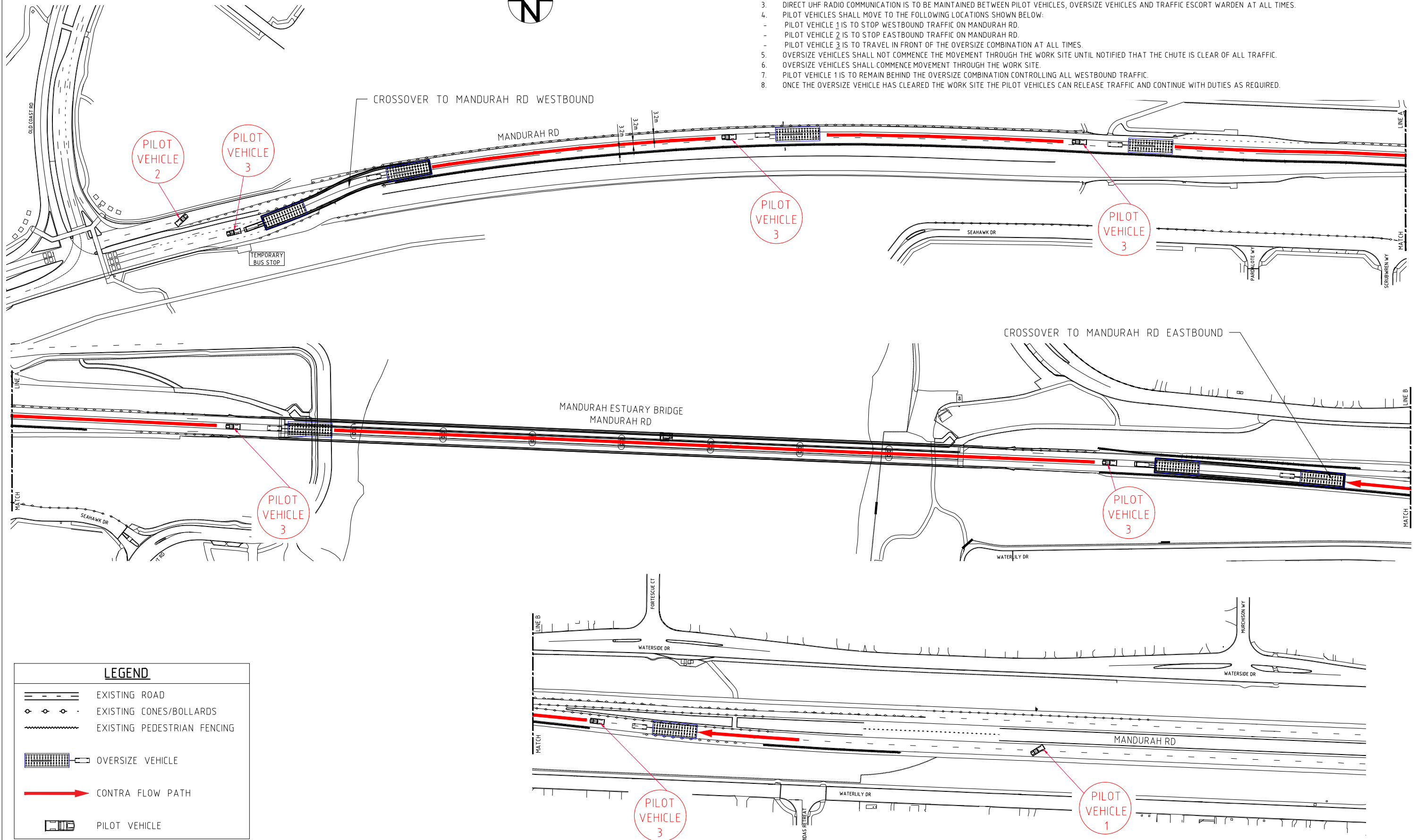

METHODOLOGY:

1. MINIMUM 3 PILOT VEHICLES REQUIRED TO FACILITATE THE MOVEMENT THROUGH THE WORK SITE.
2. ROAD NETWORK OPERATION CENTER SHALL BE CONTACTED (138 111) PRIOR TO COMMENCING THE MOVEMENT THROUGH THE WORK SITE.
3. DIRECT UHF RADIO COMMUNICATION IS TO BE MAINTAINED BETWEEN PILOT VEHICLES, OVERSIZE VEHICLES AND TRAFFIC ESCORT WARDEN AT ALL TIMES.
4. PILOT VEHICLES SHALL MOVE TO THE FOLLOWING LOCATIONS SHOWN BELOW:
  - PILOT VEHICLE 1 IS TO STOP WESTBOUND TRAFFIC ON MANDURAH RD.
  - PILOT VEHICLE 2 IS TO STOP EASTBOUND TRAFFIC ON MANDURAH RD.
  - PILOT VEHICLE 3 IS TO TRAVEL IN FRONT OF THE OVERSIZE COMBINATION AT ALL TIMES.
5. OVERSIZE VEHICLES SHALL NOT COMMENCE THE MOVEMENT THROUGH THE WORK SITE UNTIL NOTIFIED THAT THE CHUTE IS CLEAR OF ALL TRAFFIC.
6. OVERSIZE VEHICLES SHALL COMMENCE MOVEMENT THROUGH THE WORK SITE.
7. PILOT VEHICLE 1 IS TO REMAIN BEHIND THE OVERSIZE COMBINATION CONTROLLING ALL WESTBOUND TRAFFIC.
8. ONCE THE OVERSIZE VEHICLE HAS CLEARED THE WORK SITE THE PILOT VEHICLES CAN RELEASE TRAFFIC AND CONTINUE WITH DUTIES AS REQUIRED.



**LEGEND**

- EXISTING ROAD
- EXISTING CONES/BOLLARDS
- EXISTING PEDESTRIAN FENCING
- OVERSIZE VEHICLE
- CONTRA FLOW PATH
- PILOT VEHICLE

No.	DATE	DESCRIPTION	YK	APPR.
0	03.02.25	ISSUED FOR APPROVAL		
ISSUE AND REVISION HISTORY				

CLIENT:

SCALE: NTS

TRAFFIC & SAFETY PTY LTD

REVIEWED BY: A.ANASTAS  
 AWTM NO.: 23-07338-03  
 DATE: 03/02/25  
 DESIGNED BY: YUYANG KE  
 AWTM NO.: 22-6370-03  
 DATE: 02/03/25

TITLE: MANDURAH ESTUARY BRIDGE DUPLICATION  
 OSOM VEHICLE CONTRA FLOW  
 ON MANDURAH RD EASTBOUND

DRAWING NUMBER: MEBD-TCP04-OSOM3  
 REV: 0