

**NOTES:**

1. Minimum 4 Pilot vehicles required to facilitate contra flow movement.
2. Direct UHF radio communication is to be maintained between Pilot vehicles, Oversize vehicle(s) and Traffic Escort vehicle (if applicable) at all times.
3. Pilot vehicles 1, 2 & 3 shall move to the locations shown and stop all traffic to allow the Oversize vehicle(s) to execute the contra flow manoeuvre:
  - Pilot vehicle 1 shall stop eastbound traffic prior to the off-ramp to Wilson Street;
  - Pilot vehicle 2 shall stop westbound traffic turning into the Wilson Street on-ramp;
  - Pilot vehicle 3 shall stop northbound traffic on Wilson Street Northbound until the Oversize vehicle(s) have progressed onto the off-ramp from Great Northern Highway.
3. Oversize vehicle(s) shall not begin the contra flow maneuver until notified that all traffic is stopped and the ramp from Great Northern Highway is clear of traffic.
4. Once the Oversize vehicle(s) have passed the intersection for eastbound traffic from Great Northern Highway entering Wilson Street via ramp, Pilot Vehicle 2 shall release traffic and proceed to Location 2, then stop traffic at that location until the Oversize vehicle(s) have returned to the natural lane on Great Northern Highway westbound.
5. Once the Oversize vehicle(s) are traveling westbound on Great Northern Highway the Pilot vehicles can release traffic and continue with duties as required.

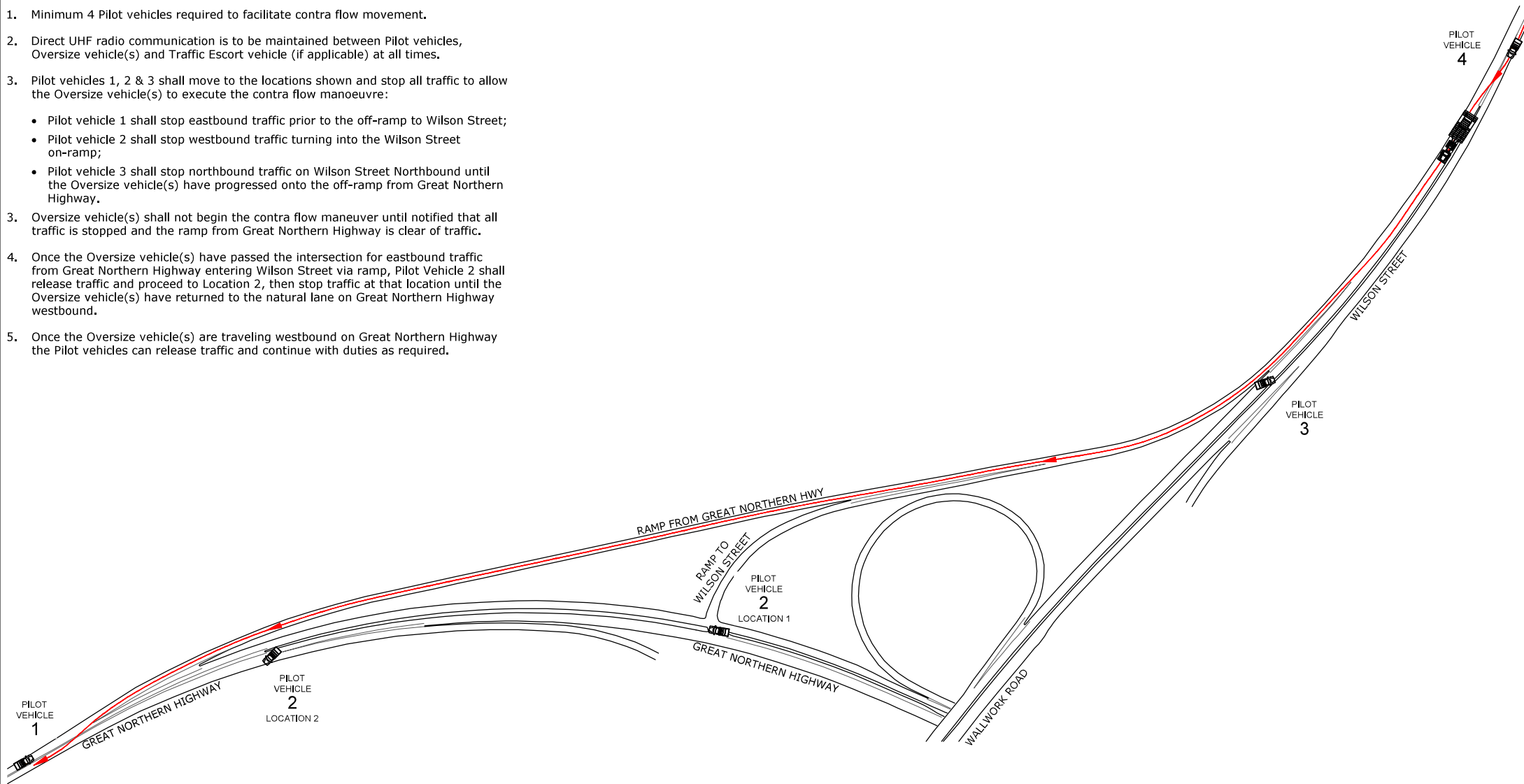

**TRAFFIC FORCE**  
 P: 1300 256 000  
 E info@trafficforce.com.au  
 W www.trafficforce.com.au

Client: MRWA HEAVY VEHICLE SERVICES	
Location: WILSON STREET SOUTHBOUND INTO GREAT NORTHERN HWY WESTBOUND, PORT HEDLAND	
Title: OVERSIZE VEHICLE MOVEMENT WESTBOUND CONTRA FLOW ROUTE INTO GREAT NORTHERN HIGHWAY	
Posted Speed: 80 kph	Temporary Speed: N/A

**LEGEND**

	Contra flow path
	Pilot vehicle
	Oversize vehicle

**DISCLAIMER**  
 This TGS is intended for use only with works managed by Main Roads WA Heavy Vehicle Services and its authorised representatives. Traffic Force is not responsible for misuse and/or alterations which are not authorised by Traffic Force.

TGS No.: RM0395-18-09	Revision: C	Paper Size: A3
Date: 11 OCTOBER 2019	Scale: Not to Scale	
Designed by: DALLAS MILLWARD AUS-AWTM-18-2352-02		
Reviewed by: TEGAN STUDSOR ETA-AV-17-30889-03		

NORTH